

Manufactured for & Marketed by :  
**Lifelong Online Retail Private Limited**  
Made in China  
For queries and complaints:  
please contact: [customercare@lifelongonline.com](mailto:customercare@lifelongonline.com)  
[www.lifelongindiaonline.com](http://www.lifelongindiaonline.com)

# وسلونا

## COMPLETE GROOMING KIT

User Manual



Built for Style. Built for India.

## INTRODUCTION:

Dear Customer,  
Congratulations!

We welcome you to the Lifelong family, as you welcome the Lifelong Complete Grooming Kit to be a part of your home.

At Lifelong, our products are carefully built for the needs of India, which is why we have crafted a diverse range of innovative products, across a spectrum of categories - Home, Kitchen, Grooming, Fitness, Lifestyle and Smart Home, to better help you. We then deliver them at the best prices, enriching your everyday living.

We are sure you can't wait to start using your new Lifelong Complete Grooming Kit. We know we can't!

Looking forward to building our bond for life, cheers!

Thank you,  
Team Lifelong

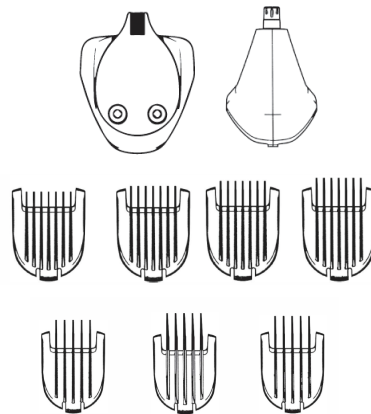
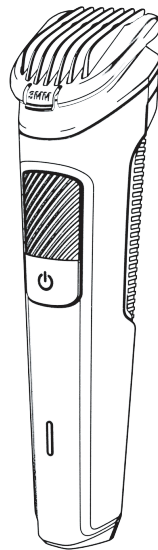

**LLPCM304**

## TABLE OF CONTENTS:

1. Precautions Before Use
2. Technical Specifications
3. Marking of the Product
4. Charging the Battery
5. Operating Instructions
6. Cleaning and Disposal
7. Terms & Conditions
8. Warranty Card

## PRECAUTIONS BEFORE USE:

- This product is for use on human hair only. Do not use the product for any other purpose.
- It is designed for private use and is not suitable for commercial purposes

### Safety Warnings

DANGER to Children and People with Restricted Capabilities of Operating Electronic Devices

- Children must not be allowed to play with the appliance. Keep children under the age of 8 away from the adapter. Keep the appliance out of the reach of children when not in use.
- This product can be used by children aged 8 and over, but it can't be used by people with physical incapability, sensory or mental incapability or lack of experience/knowledge, of whom must be supervised by people who have been trained about proper use and understand the potential dangers. Children must not clean the product without being supervised, unless over 8 years old.
- Keep all the products in the package away from children in case of a risk of suffocation!

### Danger Due to Electricity

- Do not use the beard trimmer directly in the bath or shower within a distance of 1 metre from the bath or shower, or above a washbasin filled with water while operated by adapter, nor should you charge it in any above places, in case it should fall into the water.

- Do not reach for the beard trimmer if it has fallen into water while charged by the adapter. Unplug the mains adapter from the wall socket immediately. Let the appliance dry completely.
- If the beard trimmer becomes wet during battery operation or while cleaning it, let it dry.
- Do not charge the product outdoor or in rooms with high humidity.
- Never touch the mains adapter with damp hands when plugging it in or unplugging it from the wall socket.
- Do not use the beard trimmer if the appliance itself, the connection cord or the mains adapter show visible signs of damage or if the appliance has been dropped.
- Do not make any modifications to the product.

#### **Warning - Risk of Injury**

- Do not use the beard trimmer if the trimmer head or hair guard is defective.
- Only use the original accessories.
- The trimmer head is extremely sharp. Be careful when using the appliance without a hair guard.

#### **CAUTION - Material Damage**

- Always plug the cord into the connection socket on the beard trimmer before plugging the mains adapter into a wall socket.
- Do not attempt to open the casing. The rechargeable battery is firmly built in and cannot be replaced yourself.
- Thoroughly clean the appliance after each use as described in the section "Cleaning the appliance". Do not use any caustic, corrosive or abrasive products for cleaning.

- Protect the appliance and mains adapter from impacts, falls, dust, moisture, direct sunlight and extreme temperatures. Never expose the appliance to temperatures below +5°C or above +40°C for prolonged periods of time.

## **TECHNICAL SPECIFICATIONS :**

Rechargeable Battery : 1 x lithium-ion rechargeable

Battery : 500 mAh

Battery charging time: approx. 1.5 hours

Battery operation time: approx. 2 hours

Ambient temperature: +10°C to +40°C

## MARKING OF THE PRODUCT:

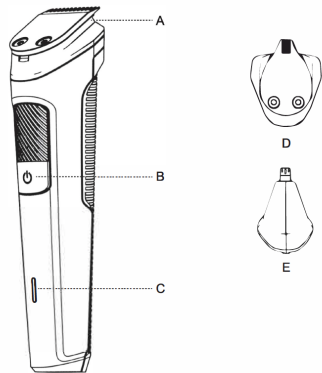

- A. Full-size hair trimmer
- B. On/off button
- C. Battery status indicator
- D. Precision trimmer
- E. Nose and ear trimmer
- F. Stubble guard (1 mm)
- G. Hair guard(3mm)
- H. Hair guard(5mm)
- I. Hair guard(7mm)
- J. Hair guard(9mm)
- K. Hair guard(12mm)
- L. Hair guard(16mm)
- M. Charging cord
- N. Cleaning brush



D



E



F



G



H



I



J



K



L



M



N

## CHARGING THE BATTERY:

### CAUTION - Material Damage

Before using the appliance for the first time, the rechargeable battery must be fully charged. The appliance must be switched off to do so.

- Always plug the cord into the beard trimmer before plugging the adapter into a wall socket. The charging indicator light lights up as red while charging, Charging takes about 1.5 hours. As soon as the battery is fully charged, the charging indicator light will light up as green.
- Remove the mains adapter from the wall socket after charging. You can now use the appliance in battery-operated mode for approx. 2 hours.
- The battery will need to be charged again once the charging indicator light starts to flash red during operation.

### Note:

The charging cycle will be interrupted if the appliance is switched on during charging.

### Information on the Rechargeable Battery

We recommend that you do not recharge the battery after each use. To maintain the full charging capacity of the battery, only charge the battery if the beard trimmer has not been used for a long time or when the battery is completely out of power. In such cases it should be recharged fully.

If you do not use the appliance for long periods of time, you should also completely discharge and then recharge the battery twice a year. Charge the battery in an environment between +10°C and +40°C.

## 5-Minute Fast Charge

Charge the beard trimmer for 5 minutes if you're in a hurry, and it will last for 10 minutes to meet your needs for wireless and effortless beard trimming.

If the appliance has not been used for a long time, the battery may need to be reactivated - you need to recharge the battery as described at the beginning of this chapter.

## Before starting - a Few Helpful Tips for Trimming Your Beard Correctly

The beard must be clean and dry for trimming. First wash your beard and then let it dry completely.

- Carefully comb your beard before trimming it in order to trim at any tangles. Then comb the beard hair against the direction of growth from bottom to top so that all hairs are going in the same direction.
- Trim the beard in stages, i.e. a little at a time until you reach the desired length. Select the comb attachment accordingly and set the desired cutting length. Start off- especially if you are not very experienced with the appliance - with a longer setting at first and then slowly work down to the desired length.
- To trim the beard, you can guide the beard trimmer either in the direction of growth or against it.
- To trim sideburns, guide the beard trimmer against the direction of growth.
- The cutting head will automatically stop if you cut too quickly or cut too much hair at once. If this happens, let the appliance run freely for a moment to clear itself. If this doesn't help, the cutting head needs to be cleaned - see chapter "Cleaning the appliance".
- Using the cutting head without the guards enables you to define outlines in your beard more precisely and to shave areas on your neck and temples.

- Once you are finished trimming, wash your beard again to clean out any remaining cut hairs.
- Other useful tips, tricks and ideas as well as detailed tutorials on beard trimming can be found online.

## OPERATING INSTRUCTIONS:

Always check the product and all accessories before using. Do not use the product or any accessory if it is damaged, as this may cause injury. Always replace a damaged part with one of the original type.

**Note:** Switch off and clean the product and attachments after each use.

- Use this product for its intended household use as described in this manual.
- For hygienic reasons, the product should only be used by one person.
- Trimming is easier when the skin and hair are dry.
- Be careful when trimming without a guard as when the product is turned on, it will trim every hair it touches.

## Detach and Attach Cutting Elements

1. Directly push the cutting head upwards at the back of the trimmer to detach and remove it. (Fig.1)

2. To attach a trimmer head, insert the lug of the trimmer head into the guiding slot and push the back of the trimmer head onto the product ('click') (Fig. 2)

3. To attach any type of guard onto a cutting element, slide the front part of the guard onto the teeth of the cutting element. Then press down the center of the guard with your fingers or the palm of your hand. ('click') (Fig. 3).

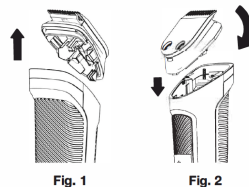

4. To detach any type of guard from the cutting element, carefully pull its back part off the product and then slide it off the cutting element (Fig. 4).

Note: When trimming for the first time, start by using the guard with the maximum trimming length setting to familiarize yourself with the product.

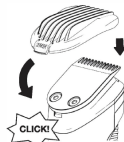

Fig. 3

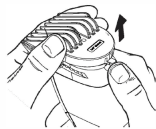

Fig. 4

### Switching the Product on and off

1. Press the on/off button once to turn the product on or off.

### Nose and Ear Trimmer

You can use the nose and ear trimmer to trim your nose hair and ear hair.

- Make sure your nasal passages are clean. Make sure your outer ear channels are clean and free from wax.
- Do not insert the tip more than 0.5cm/3/16in deep.
- Always clean the attachment after each use.

### Trimming Nose Hair

Gently move the tip in and out of your nose while turning it around to remove unwanted hairs (Fig. 5).



Fig. 5



Fig. 6

### Trimming Ear Hair

1. Slowly move the tip around the ear to remove hairs that stick out beyond the rim of the ear.
2. Gently move the tip in and out of the outer ear channel to remove unwanted hairs (Fig. 6).

### Precision Trimmer

Use the precision trimmer without a guard to create fine lines and contours around your facial style, close to the skin (to a length of 0.5mm/1/32in).

Hold the precision trimming head perpendicular to the skin and move the trimming head upwards or downwards with gentle pressure (Fig. 7).

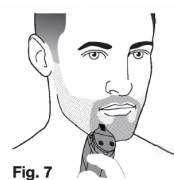

Fig. 7

### Attachments for Use on Beard

#### Full-Size Trimmer

Use the full-size metal trimmer without a guard to trim hair close to the skin or to create clean lines around your beard, neck and sideburns close to the skin (to a length of 0.5mm/1/32in).

1. To trim hair close to the skin, place the flat side of the trimmer head against your skin and make strokes against the direction of hair growth (Fig. 8).
2. For contouring hold the trimmer head perpendicular to the skin and move it upwards or downwards with gentle pressure. (Fig. 9).



(Fig. 8)



(Fig. 9)

**Guide Combs**

When attached to the full-size trimmer, use the 3 beard guide combs, 1 stubble guide comb and 3 hair guide combs to evenly trim your hair.

Guard Type	Color	Length (mm)	Length (in)
Stubble	Light Grey	1 mm	1/16"
Beard	Dark Grey	3 mm	1/8"
		5 mm	13/64"
		7 mm	9/32"
Hair	Black	9 mm	23/64"
		12 mm	15/32"
		16 mm	5/8"

- 1. To attach the guard, simply slide it onto the teeth of the cutting element, and press down the center of the guard.
- 2. To remove the guard, gently pull the back part of the guard and slide it off the cutting element.
- 3. Attach the guard to the full-size hair trimmer.
- 4. To trim in the most effective way, move the guard against the direction of hair growth (Fig.10). Make sure the surface of the guard always stays in contact with the skin.



**CLEANING AND DISPOSAL:**

- 1. Slide the On/Off switch downwards to switch the appliance off.
- 2. Clean the appliance as described in the section "Cleaning the appliance".

**Cleaning Methods**

Only the trimmer heads and the guide combs can be rinsed under the tap. Never use scouring pads, abrasive cleaning agents, or aggressive liquids such as gasoline or acetone to clean the product.

- 1. Switch off the product and disconnect it from the wall outlet.
- 2. Wipe the body of the product with a dry cloth.
- 3. Remove any guide comb or trimmer head from the product.
- 4. Blow out any accumulated in the hair chamber (Fig.11).
- 5. Blow out any hair collected in the trimmer heads and guide combs.
- 6. Clean the trimmer heads and the guide combs (Fig. 12) under a lukewarm tap after every use.
- 7. Carefully shake off excess water and let all parts dry thoroughly. Never dry the trimmer teeth with a towel or tissue, as this may damage the trimmer teeth.
- 8. Brush out the cutting head socket (area underneath the removed cutting head) with the supplied cleaning brush.
- 9. Place the cleaned cutting head back on its socket and press it in until it snaps into place.



(Fig.11)

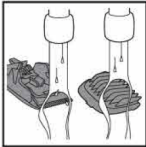

(Fig.12)



## Oiling the Cutting Head

If you use the appliance regularly, the cutting head should occasionally be oiled. Use acid-free oil for this purpose.

1. Remove the cutting head from the appliance as described in the section "Cleaning the cutting head".
2. Apply one or two drops of oil between the cutting teeth.
3. Place the cutting head back onto the appliance and briefly switch the beard trimmer on and off again to distribute the oil.
4. Wipe off excess oil with a cloth.

## Replacing the Cutting Head

### CAUTION - Material Damage

- Only Use The Original Attachments. Never Attempt To Sharpen The Cutting Head Yourself!

Replace/Remove the cutting head from the appliance as described in the section "Detach and attach cutting elements" and replace it with a new one. Contact our customer service to enquire about replacement cutting heads.

## Disposal

Dispose of the packaging at a recycling point that sorts materials by type. Make use of the local facilities provided for collecting paper, cardboard and lightweight packaging.

Appliances marked with this symbol as well as flat rechargeable batteries must not be disposed of along with household refuse! You are legally bound to dispose of old appliances separately to household waste and useless rechargeable batteries at a local authority collection point.

Warning! This appliance contains a battery that for safety reasons is firmly built into the appliance and cannot be removed without destroying the casing. Improper disassembling presents a safety hazard. Therefore, turn in the appliance intact at a collection point where appliances and rechargeable batteries are properly disposed of. Information about collection points where old appliances can be disposed of free of charge is available from your local authorities.

## Terms and Conditions:

1. This warranty is void if:
  - a. The completely filled warranty card is not presented at the time of servicing the product.
  - b. The product is not operated according to the instructions given under the user manual.
  - c. Damages are caused by lightning, abnormal voltage, water or other liquid intrusion, fire, flood, accident, negligence or improper handling.
  - d. Product has been damaged due to installation, repairs, alterations or modifications by unauthorized service organizations or persons.
  - e. Product label specifying the model number, serial number and production code has been removed and altered.
  - f. Defects or parts requiring replacement due to ordinary wear and tear, corrosion, rust or stains, scratches, dents on the casing or paintwork of the product.
  - g. Claims damaged and/or missing parts (accessories) after 7 days from the original date of goods received.
  - h. Defects or faults in product which have been used for commercial/industrial purposes or which have been rented/leased or have been otherwise subject to non-household/non-domestic use.
2. Repairs or replacements will be carried out by authorized service provider.
3. During the limited warranty period, Lifelong or its authorized service provider will repair without charge the defective unit inclusive of labor and parts and restore the unit to its optimum working condition. All defective parts used for the warranty repair should be surrendered to Lifelong and/or its authorised servicer.
4. All expenses incurred in collecting the unit (s) or part(s) thereof from authorised service provider as well as any other expenses and incidentals will be borne by the consumer.

5. Lifelong obligations are limited to the repair and replacement of the defective product. Except as set forth above, there are no other express or implied warranty and all warranted, conditions or other terms implied by statute or common law (including any warranty of satisfactory quality, merchantability or fitness for a particular purpose) are excluded to the fullest extent permitted by the law.
6. Lifelong total liability for damages relating to or arising out of the purchase or use of the product regardless of the type or cause of such damage of the form of characterization of the claim asserted (e.g. contract or tort) shall not exceed the original purchase price paid for the product.
7. However in no event shall Lifelong and Lifelong authorized distributors be liable for any punitive, special incidental, indirect or consequential losses or damages whatsoever (including without limitation, damages for the loss of revenue, business, profits, goodwill, or contracts, business interruptions, loss of business information or any other pecuniary loss.) Whether or not Lifelong has been advised of the possibility of such damages. These limitations shall apply not with standing the failure of the essential purpose of any limited warranty. This limited warranty does not affect consumer's statutory rights under the law.
8. No carrier, dealer or employee is thereof authorized to make modifications to this warranty and you should not rely on any such representation. Lifelong reserves the right to amend the terms and conditions if necessary.

## Consumer Warranty Card

Dear Customer,

Thank you for choosing a Lifelong consumer product. All Lifelong Consumer products are designed and manufactured to the highest standards to deliver high quality performance, as well as easy installation and use. At Lifelong, we believe in providing not only service, but adding value to your purchase. The warranty has therefore been designed especially for you with your interest at heart.

### Warranty Service

All Lifelong consumer products are covered against manufacturing defects from their date of purchase.

Name of the product: \_\_\_\_\_

Model: \_\_\_\_\_

Warranty coverage: 1 year

Please note: Purchase receipt is necessary for warranty verification.

Customer Care: [customercare@lifelongonline.com](mailto:customercare@lifelongonline.com)

### Customer Details

Name: \_\_\_\_\_

Address: \_\_\_\_\_

Home Number: \_\_\_\_\_

Office Number: \_\_\_\_\_

E-mail Address: \_\_\_\_\_

### Product Details

Model No.: \_\_\_\_\_

Serial No.: \_\_\_\_\_

Purchase Date: \_\_\_\_\_

Invoice Number: \_\_\_\_\_

Online Site: \_\_\_\_\_

Please log onto to [www.lifelongindiaonline.com](http://www.lifelongindiaonline.com) and complete the online warranty form with your personal and product details within 14 days.