

Manufactured for & Marketed by :

**Lifelong Online Retail Private Limited**

For queries and complaints:  
please contact: [customercare@lifelongonline.com](mailto:customercare@lifelongonline.com)  
[www.lifelongindiaonline.com](http://www.lifelongindiaonline.com)

# lifelong

## VACUUM CLEANER

User Manual

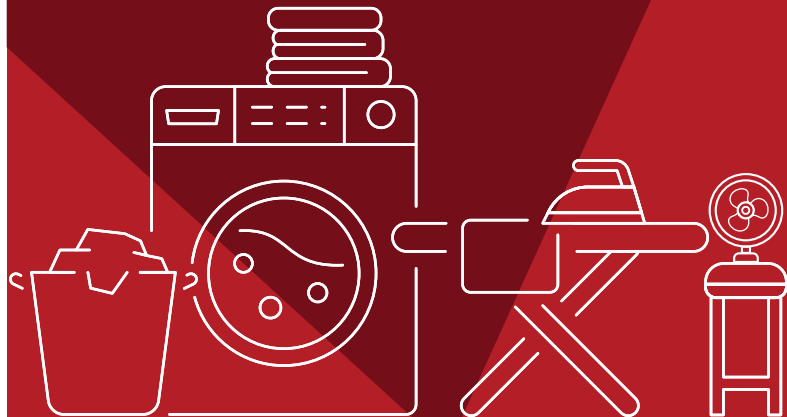

**Built for Home. Built for India.**

## INTRODUCTION:

Dear Customer,

Congratulations! We welcome you to the Lifelong family, as you welcome Lifelong Vacuum Cleaner to be a part of your home.

At Lifelong, our products are carefully built for the needs of India, which is why we have crafted a diverse range of innovative products, across a spectrum of categories - Home, Kitchen, Grooming, Fitness, Lifestyle and Smart Home, to better help you. We then deliver them at the best prices, enriching your everyday living.

We are sure you can't wait to start using your new Lifelong Vacuum Cleaner.

We know we can't!

Looking forward to building our bond for life, cheers!

Thank you,  
Team Lifelong

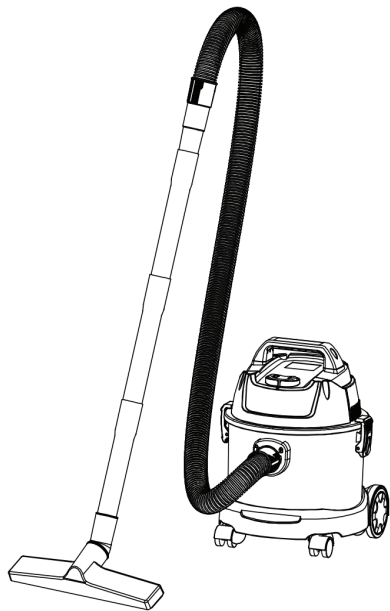

**LLVC930**

## TABLE OF CONTENTS:

1. Product Characteristics
2. Structure And Parts Name
3. Safety Instructions
4. Operation Method
5. Protective Device (Water Valve)
6. Maintenance
7. Tech Data
8. Breakdown Table
9. Warranty Information
10. Correct Disposal of This Product
11. Terms And Conditions
12. Warranty Card

## PRODUCT CHARACTERISTICS :

1. Vacuum cleaner for wet and dry
2. Jacks on the base, easy for depositing accessories
3. Blowing function, satisfy different requirements

## STRUCTURE AND PARTS NAME :

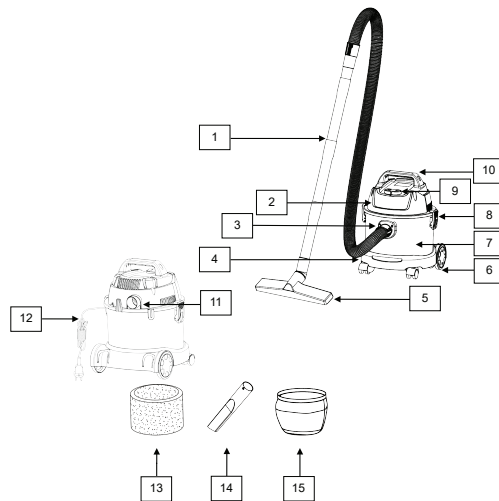

1. Plastic tubes (3pcs)
2. Head unit
3. Suction port
4. Base
5. Wet & dry brush
6. Wheels (2x 360° swivel & 2x universal)
7. Tank
8. Plastic clips
9. Switch
10. Handle
11. Blower
12. Power cord
13. Sponge filter (For wet)
14. Crevice nozzle
15. Clothes bag (For dry)

## Use the right accessories according to different situations.

Brush for bookshelves, windows and bibulous brush for floor, carpet, and tables, etc.

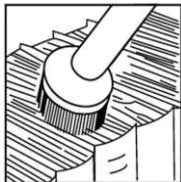

Crevice nozzle for crevice, corner, etc. Blowing mouth for blowing the dust away in the crevice of the machine

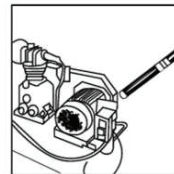

## SAFETY INSTRUCTIONS :

1. Check before operation that the local power supply is the same as the specification on the rating label.
2. Do not use machine in the combustible and explosive place in case the motor spark causes fire.

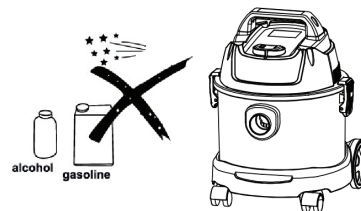



3. Do not jam the air inlet in case temperature rises and damage the motor.

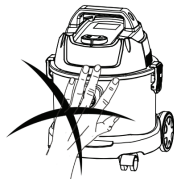

4. Do not collect combustible and explosive objects such as burning cigarettes, gasoline, etc.



\*Do not collect sharp objects.

\*Do not collect objects which can easily stick to the filter such as calcareousness powder, gesso and graphite powder. Because they will block the ventilation and damage motor.

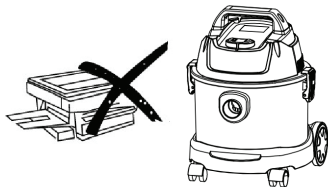

5. Do not overturn the machine in case water goes into the motor and damages it.

6. Warning: do not overturn the machine in case water goes into the motor and causes damage. Do not use this machine as pump in case of motor burn.

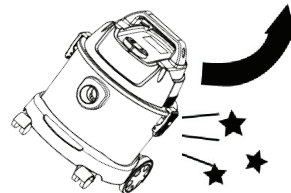

7. Turn off the machine and remove the plug each time after use or under repairment.

8. Keep the machine away from strong sunlight and high temperature in case plastic is distorted.

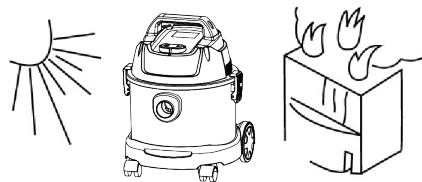

9. Do not wrest, tramp, or haul hose in case of making it damaged.
10. Do not immerse the barrel cap into the water or wash with water in case water goes into the electrophorus parts and causing person injury.  
The correct way should be: immerse the dishcloth firstly, and then dry it. Finally, wipe the dirty part gently.
11. The power cord must be replaced by the designated repairing center or professionals.

## OPERATION METHOD :

### (1) Connection

Insert the hose connector into the suction port, as shown in the picture; make sure the connector is tightly fastened.

Pull the hose out from the suction port for disassembling.

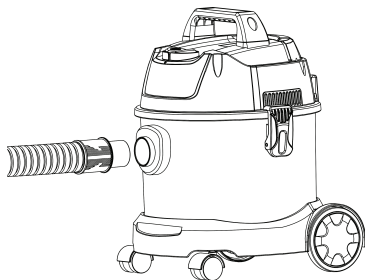

As shown in the picture, connect all the accessories for wet & dry cleaning.

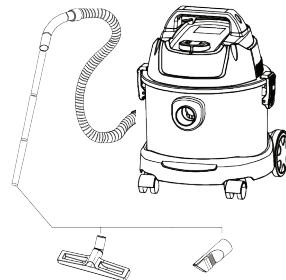

As shown in the picture, connect all the accessories for wet & dry cleaning.

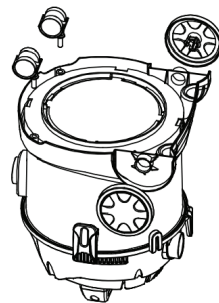

Insert the hose connector into the blower port as it's shown in the picture when you want to use the blower.

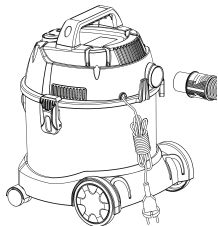

## (2) Operation

1. Insert the plug into the power socket.
2. Switch - I stands for power on, and O stands for power off.

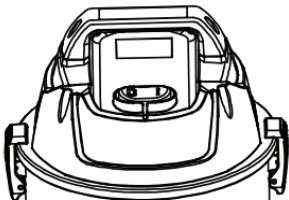

## (3) Filters

As the following picture shows, different filters should be used in different cases.

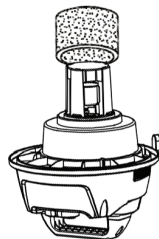

**Sponge filter** should be assembled onto the water valve in any case of cleaning spillage and liquid.

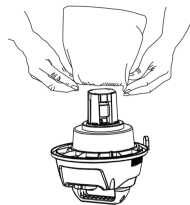

**Cloth filter** should be assembled onto the water valve in any case of cleaning cleaning dry dust and debris.

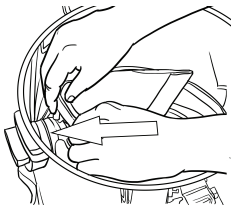

**Dust collection** bag should be locked onto the inside part of suction port in any case of cleaning cleaning dry dust, debris, rubbish, etc.

Warning: Only use the sponge filter for cleaning liquid.

Cloth bag, dust collection bag and HEPA filter are optional; check which ones are included before buying, or from the outer box.

## **PROTECTIVE DEVICE (WATER VALVE) :**

Special instruction concerning the water valve.

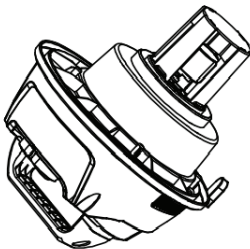

1. When the water in the barrel is full, the device begins to work.

The suction power will vanish at this moment. The machine will make some noise which indicates the motor is running at a high speed.

Under this circumstance, please cut off power, and clean up the water. Then equip the machine and turn it on. It will begin to work normally.

2. When the machine is overturned, the device will begin to work. You should cut off the electricity and keep it upright, then switch on the machine.

3. When the device is working, the motor will be damaged and burns if you use the machine. Under this circumstance, please stop using and clean up the water.

## **MAINTENANCE :**

### **(1) Barrel Cleaning**

\* After working or when the barrel is full of dust which causes suction decrease, considerably, please switch off the vacuum cleaner and clean the barrel.

1. Unfasten the clips, lift up the top cover.
2. Take out the cloth filter, clean the barrel inside and dry it.
3. Dry both the barrel and filters and reset them before use.

### **(2) Filter Cleaning**

\* Filters should be washed by clean and warm water if they are messy. Otherwise it might cause suction reduction or even worse filtration. Gentle cleansers can be used for cleaning.

Warning: Filters should be dried before use. It's suggested to replace the old filters with new ones at regular intervals for keeping the best suction and filtration.

## TROUBLESHOOTING CHART :

Symptom	Possible cause	Corrective action
Dust / liquid leaks from the telescopic tube/plastic hose/ suction port	Accessories are not connected well.	Make sure the accessories are connected tightly and properly.
Weak suction	1. Filter/plastic pipe/plastic hose/suction port is blocked. 2. The barrel is not lidded well.	1. Clean the filter and the accessories or use the filter-cleaning function. 2. Check the head and the clips.
Unnormal noise when working	Too much water inside/unit is turned over, so that the valve blocks the air inlet.	Pour out the water in tank or place the unit rightly.
Unit begins to smoke	Overheated, overloaded or damaged motor.	Turn off the unit and send it for repairment.
Poor filtration	Filters are used for too long a time.	Contact with your dealer for buying new ones.

## TECHNICAL SPECIFICATIONS :

Product	Vacuum Cleaner
SKU ID	LLVC930
Use For	Wet & Dry
Power	800 W
Voltage	220-240 V
Frequency	50-60 Hz, 1 Phase

Blower	Yes
Capacity	6 litres

## Terms and Conditions:

1. This warranty is void if:
  - a. The completely filled warranty card is not presented at the time of servicing the product.
  - b. The product is not operated according to the instructions given under the user manual.
  - c. Damages are caused by lightning, abnormal voltage, water or other liquid intrusion, fire, flood, accident, negligence or improper handling.
  - d. Product has been damaged due to installation, repairs, alterations or modifications by unauthorized service organizations or persons.
  - e. Product label specifying the model number, serial number and production code has been removed and altered.
  - f. Defects or parts requiring replacement due to ordinary wear and tear, corrosion, rust or stains, scratches, dents on the casing or paintwork of the product.
  - g. Claims damaged and/or missing parts (accessories) after 7 days from the original date of goods received.
  - h. Defects or faults in product which have been used for commercial/industrial purposes or which have been rented/leased or have been otherwise subject to non-household/non-domestic use.
2. Repairs or replacements will be carried out by authorized service provider.
3. During the limited warranty period, Lifelong or its authorized service provider will repair without charge the defective unit inclusive of labor and parts and restore the unit to its optimum working condition. All defective parts used for the warranty repair should be surrendered to Lifelong and/or its authorised servicer.
4. All expenses incurred in collecting the unit (s) or part(s) thereof from authorised service provider as well as any other expenses and incidentals will be borne by the consumer.

5. Lifelong obligations are limited to the repair and replacement of the defective product. Except as set forth above, there are no other express or implied warranty and all warranted, conditions or other terms implied by statute or common law (including any warranty of satisfactory quality, merchantability or fitness for a particular purpose) are excluded to the fullest extent permitted by the law.
6. Lifelong total liability for damages relating to or arising out of the purchase or use of the product regardless of the type or cause of such damage of the form of characterization of the claim asserted (e.g. contract or tort) shall not exceed the original purchase price paid for the product.
7. However in no event shall Lifelong and Lifelong authorized distributors be liable for any punitive, special incidental, indirect or consequential losses or damages whatsoever (including without limitation, damages for the loss of revenue, business, profits, goodwill, or contracts, business interruptions, loss of business information or any other pecuniary loss.) Whether or not Lifelong has been advised of the possibility of such damages. These limitations shall apply not with standing the failure of the essential purpose of any limited warranty. This limited warranty does not affect consumer's statutory rights under the law.
8. No carrier, dealer or employee is thereof authorized to make modifications to this warranty and you should not rely on any such representation. Lifelong reserves the right to amend the terms and conditions if necessary.

## Consumer Warranty Card

Dear Customer,

Thank you for choosing a Lifelong consumer product. All Lifelong Consumer products are designed and manufactured to the highest standards to deliver high quality performance, as well as easy installation and use. At Lifelong, we believe in providing not only service, but adding value to your purchase. The warranty has therefore been designed especially for you with your interest at heart.

### Warranty Service

All Lifelong consumer products are covered against manufacturing defects from their date of purchase.

Name of the product: \_\_\_\_\_

Model: \_\_\_\_\_

Warranty coverage: 1 Year

Please note: Purchase receipt is necessary for warranty verification.

Customer Care: [customercare@lifelongonline.com](mailto:customercare@lifelongonline.com)

### Customer Details

Name: \_\_\_\_\_

Address: \_\_\_\_\_

Home Number: \_\_\_\_\_

Office Number: \_\_\_\_\_

E-mail Address: \_\_\_\_\_

### Product Details

Model No.: \_\_\_\_\_

Serial No.: \_\_\_\_\_

Purchase Date: \_\_\_\_\_

Invoice Number: \_\_\_\_\_

Online Site: \_\_\_\_\_

Please log on to [www.lifelongindiaonline.com](http://www.lifelongindiaonline.com) and complete the online warranty form with your personal and product details within 14 days.