

Manufactured for & Marketed by :
Lifelong Online Retail Private Limited

For queries and complaints:
please contact: customercare@lifelongonline.com
www.lifelongindiaonline.com

lifelong

CHIMNEY

User Manual

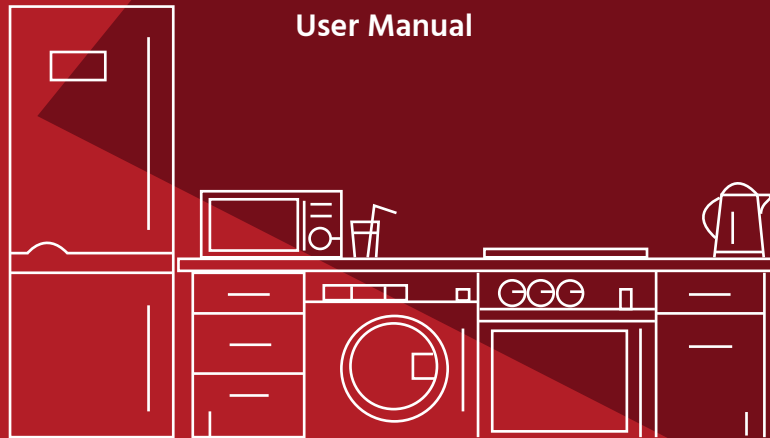

Built for Taste. Built for India.

INTRODUCTION:

Dear Customer,

Congratulations! We welcome you to the Lifelong family, as you welcome the Lifelong Chimney to be a part of your home.

We started Lifelong Online with a simple dream of being a part of every Indian household, which is why we have produced a varied assortment of innovative products across a spectrum of categories - Home, Kitchen, Grooming, Fitness, Lifestyle, and Smart Home - to better assist you.

We hope you enjoy using our Chimney as much as we enjoyed designing it for you.

Delivering promises that last lifelong.

Thank you for choosing us,

Lifelong
Built For India

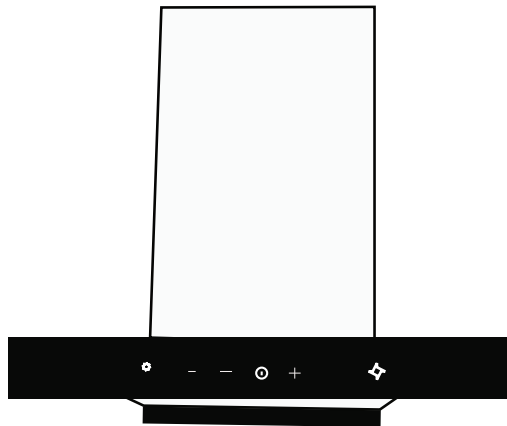

LLLACC0260

TABLE OF CONTENTS:

- 1 About the product
- 2 Safety Precautions
- 3 Installation
- 4 Maintenance
- 5 Troubleshoot Chart
- 6 Terms and conditions
- 7 Warranty

ABOUT THE PRODUCT:

Introducing Lifelong Chimney, which has auto-clean technology to let you clean your chimney with a single touch. The oil collection cup gathers oils and other wastes, making it simple to clean the chimney. The thermal auto-clean function of this chimney helps to clear the oil and other residues without the need for personal involvement.

SAFETY PRECAUTIONS

- Never let the children operate the machine.
- The cooker hood is for home use only, not suitable for barbecue, roast shop and other commercial purpose.
- The cooker hood and its filter should be clean regularly in order to keep in good working condition.
- Clean the cooker hood according to the instruction manual and keep the unit from danger of burning. There is a fire risk if cleaning is not carried out in accordance with the instructions.
- Forbid the direct baking from the gas cooker.
- Please keep the kitchen room a good convection.

Before connecting this appliance check that the power supply cord is not damaged. A damage supply cord must be replaced by qualified service personnel only.

ELECTRICAL SHOCK HAZARD

- Only plug this unit into a properly earthed outlet. If in doubt seek advice from a suitably qualified engineer.
- Failure to follow these instructions can result in death, fire, or electrical shock.

INSTALLATION INSTRUCTIONS:

Choose the type of drill bit depending on the material of the wall.

(All dimensions mentioned below are in millimetres).

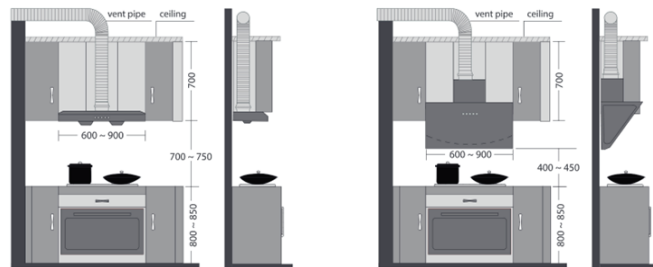
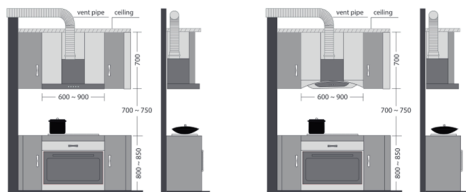

1. Prepare for installation:

- If you have an outlet to the outside, your cooker hood can be connected as below picture by means of an extraction duct (enamel, aluminium, flexible pipe or inflammable material with an interior diameter of 150mm).

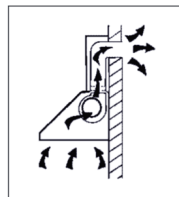

b. Before installation, turn the unit off and unplug it from the outlet.



c. The cooker hood should be placed at a distance of 65~75 cm above the cooking plane for best effect.

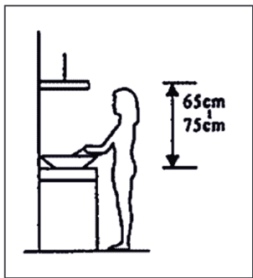

INSTALLATION (VENT OUTSIDE)

Attention! Observe the warning in the instruction sheet concerning the operation of the appliance when air is discharged from the room.

When the range hood and appliance supplied with energy other than electricity are simultaneously in operation, the negative pressure in the room must be not exceed 4 Pa (4×10⁻⁵ Bar)

- Drill 3 x 8mm holes to accommodate the bracket. Screw and tighten the bracket onto the wall with the screws & screw plugs provided.

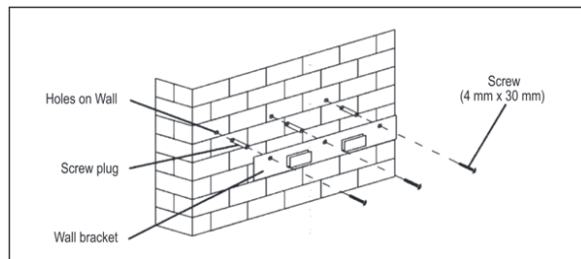

- For inclined panel Model, need to drill 4 x 8 mm extra holes & fixing screws & screw plugs before installation.

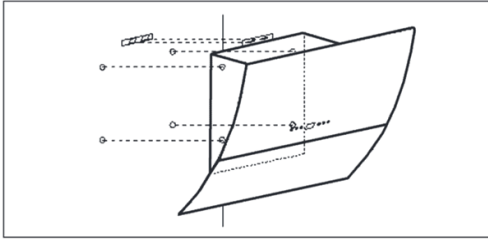

- Leave up the cooker hood and hang onto the wall bracket hook

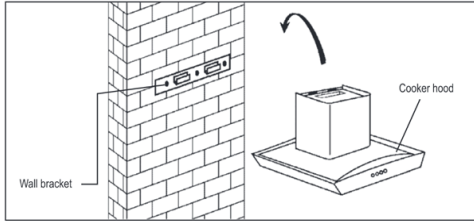

- Fix the one-way-valve to the air outlet of the cooker hood, the attach the exhaust pipe onto the one-way-valve as shown below.

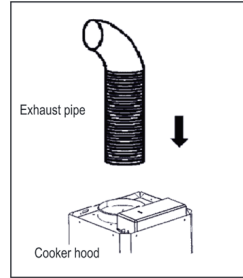

- Chimney Installation

For Glass model and T shape model

- By Put the upper chimney into lower chimney. Then pulling out the upper chimney upwards. Adjust to reach the height required.

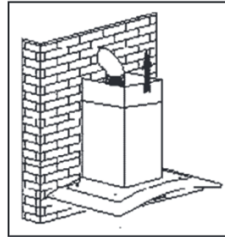

Sliding the chimney to adjust the chimney height. When the height you required is reached, then hang the fixing hole to the fixing screws as showed in below pictures.

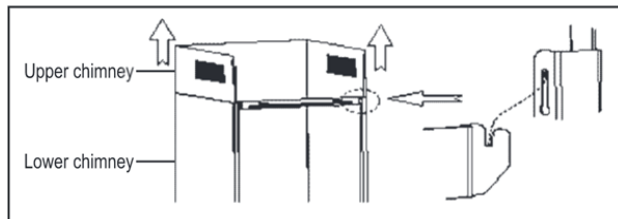

- Drill 2 x 8 mm holes to accommodate the plate II. Screw and tighten the plate II onto the wall with 2 screws provided. Assembly the chimney onto the unit and fix it with 2 screws.

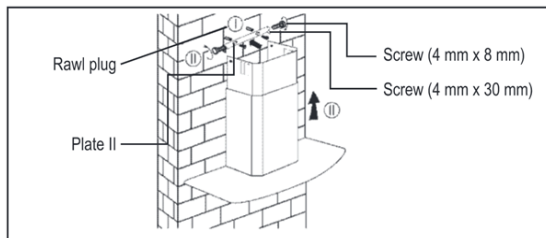

For Tower model

- By Put the inner chimney into upper chimney. Then pulling out the upper chimney upwards. Adjust to reach the height required.

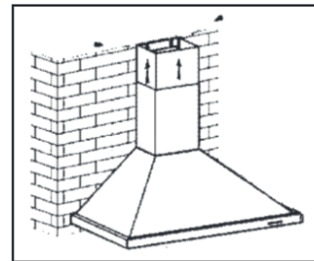

- Fix the lower chimney with 2 pcs of 4mm x 8mm screws.

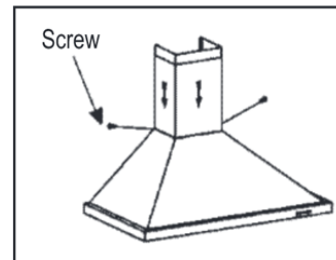

- Sliding the chimney to adjust the chimney height. When the height you required is reached, then fix 2 pcs of 4mm x 8mm screws onto the hole fixing with plate I as showed in below pictures.

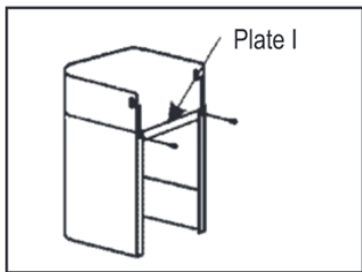

- Drill 2 x 8 mm holes to accommodate the plate II. Screw and tighten the plate II onto the wall with 2 screws provided.
- Assembly the chimney onto the unit and fix it with 2 screws.

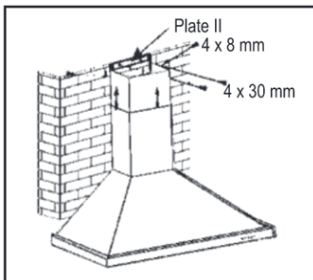

• Installation (Vent inside)

If you do not have an outlet to the outside, exhaust pipe is not required, and the installation is like the one show in section "Installation (Vent outside)"

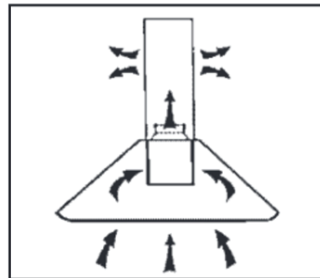

INSTALLATION OF ISLAND CHIMNEY

- Make sure of installation position, fix the hanging scaffold at proper position, and check firmness and smoothness of installation. See the pic 1.
- Adjust to proper height, joint the bracket, install on hanging scaffold. See the pic 2.
- Fix inside chimney on hanging scaffold, enclose outside chimney on it at proper position, insert hook into bracket to fix outside chimney temporarily. See the pic 3.
- Fix air outlet in the vent on hood's body, connect extensible pipe with air outlet. See the pic 4.
- Extend the hose out of hanging scaffold, fix hood's body on bracket. See the pic 5.

- Detach the hook, move outside chimney downward till reaching hood's body. Pay attention not to strike the glass. See the pic 6.

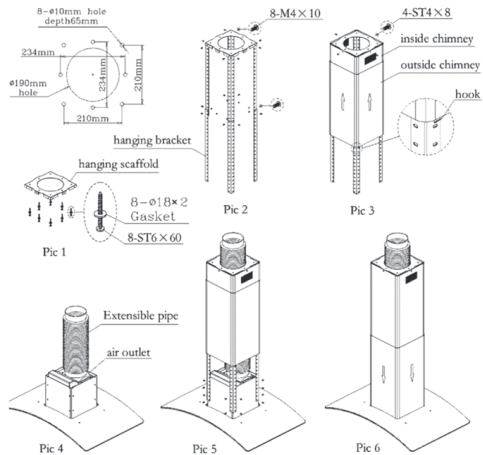

- Activated carbon filter can be used to trap odours.
- In order to install the activated carbon filter, the grease filter should be detached first. Press the lock and pull it downward.

- Installation (Vent inside)

If you do not have an outlet to the outside, exhaust pipe is not required, and the installation is like the one show in section "Installation (Vent outside)"



- Plug the activated carbon filter into the unit and turn it in clockwise direction. Repeat the same on the other side.

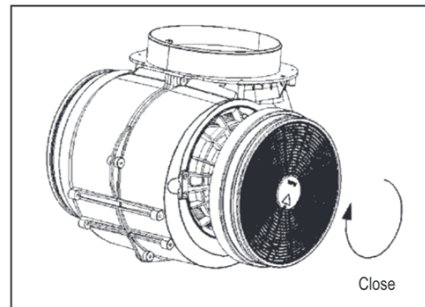

NOTE:

- Make sure the filter is securely locked. Otherwise, it would loosen and cause
- When activated carbon filter attached, the suction power will be lower.

Push Button Operation



- Power Off Button: Press this button to turn off the motor while running.
- Low Speed: Press this button to run the chimney on low speed.
- Medium Speed: Press this button to run the chimney on medium speed.
- High Speed: Press this button to run the chimney on High speed.
- Heat Auto-Clean: Press the button to run the Heat Auto-Clean function.
- Light: Press this button turn on the lamp, press again to turn off the lamp.

Function Operation:

The cooker hood is operated with gesture control and a feather touch control panel.



Touch control:

- Place your finger on the "O" Button, the lights on the control panel will glow on and the cooker hood is now in stand-by mode.
- Place your finger one more time, on "O" Button, the cooker hood will be turned off.
- Touch "L" Button, the cooker hood will start operating on LOW speed.
- Touch "M" Button, the cooker hood will start operating on MEDIUM speed.
- Touch "H" Button, the cooker hood will start operating on HIGH speed.
- Touch the " " Button, the lights will turn on. Repeat this action, the lights will turn off.
- Touch the " " Button for 3 seconds. The heat auto clean function will be started.
- Long touch the " " Button for 3 seconds in stand-by mode. The gesture control function will be locked. Repeat this action, it will be turned on.

Gesture control:

Gesture control is the ability to recognize and interpret movements of the human body in order to interact with and control a PCB system without direct physical contact. Which can avoid poor touch caused by oil/grease on hand.

Put your hand up in front of the sensor area, reasonable distance is: 50mm, then start to control cooker hood by hand gesture:

1. Hand waved left to right for the first time - Chimney starts at low speed and light will glow.
2. Hand waved left to right for the second time - chimney speed changes to medium.
3. Hand waved left to right for the third time - chimney speed changes to high.

4. If the hand is waved left to right again the chimney will follow above three processes respectively
5. Hand waved right to left - A three-minute delay timer will start. After three minutes

Auto Clean:

- A unique "Auto-Clean" function has been provided in this cooker hood.
- This cooker hood comes equipped with an oil collector tray. During cooking, the excess oil and dirt which gets sucked into the cooker hood gets drained into this oil collector.
- However, over the time, some traces of stubborn grease and oil can get stuck inside the cooker hood.
- In order to eliminate this stubborn grease and clean the cook hood from inside, we have designed this unique feature.
- This new generation auto-clean function works with the help of specially designed heating element fixed within the hood.
- Please make sure that the cooker hood is in stand-by model. Now touch the "Auto-Clean" button on the panel. A reverse timer of 10:00 minutes will get activated and the light for auto-clean will start blinking.
- After the special heater has worked for 9 minutes, the fan will automatically start operating at low speed for the balance remaining 1 minute.

- Most of the grease present within the cooker hood will get evaporated and blown out of the air-outlet. Any remaining grease will get drained out into the oil collector tray, located at the back of the filter.
- The auto-clean function will stop operating at the end of 10 minutes.
- Wait for a moment and then carefully remove the oil collector tray ensuring that you do not spill the grease.
- Drain the collected grease into a sink and clean the oil collector tray with a soft cloth.
- Fix the oil collector tray back at its place by sliding it in the rails at both the ends. Ensure that the tray is fixed properly.
- Your cooker hood is clean as new from inside now.

Delay:

- A unique "Delay" shut -off function has been provided in this cooker hood.
- Once the cooking is over, instead of switching off the appliance, touch the "⏸" Button while motor is running. A reverse timer of 3 minutes will get activated and the chimney will shut itself off after the end of this 3 minutes.
- Touch the power button "⏻" Anytime to turn of the chimney.

MAINTENANCE:

Before cleaning switch, the unit off and pull out the plug.

1. Regular Cleaning

Use a soft cloth moistened with hand-warm mildly soapy water or household cleaning detergent. Never use metal pads, chemical, abrasive material or stiff brush to clean the unit.

II. Monthly Cleaning for Grease Filter

ESSENTIAL: Clean the filter every month can prevent any risk of fire.

The filter collects grease, smoke and dust..... so the filter is directly affecting the efficiency of the cooker hood. If not cleaned, the grease residue (potential flammable) will saturate on the filter. Clean it with household cleaning detergent.

III. Annual Cleaning for Activated Carbon Filter

Apply SOLELY to unit that installed as a recirculation unit (not vented to the outside).

This filter traps odours and must be replaced at least once a year depending on how frequent the cooker hood used.

IV. Bulb Replacement

Switch the unit off and unplug the appliance.

Remove the lamp cover by unscrewing the 2 screws.

Unscrew the incandescent bulb.

Replace with the same type and rated bulb/lamp.

E14 Incandescent Bulb: (220V E14 Max 40W).

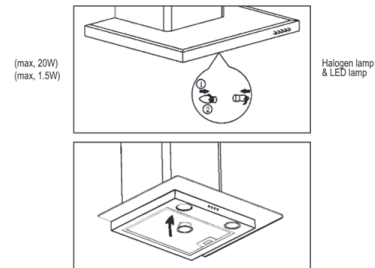

TROUBLESHOOTING:

Fault	Cause	Solution
Light on, but fan does not work	The fan blade is jammed.	Switch of the unit and repair by qualified service personnel only.
	The motor is damaged.	
Both light and fan do not work	Light bulb burn.	Replace the bulb with correct rating.
	Power cord looses.	Plug in to the power supply again.
Serious Vibration of the unit	The fan blade is damaged.	Switch of the unit and repair by qualified service personnel only.
	The fan motor is not fixed tightly.	Switch of the unit and repair by qualified service personnel only.
	The unit is not hung properly on the bracket.	Take down the unit and check whether the bracket is in proper location.
Suction performance not good	Too long distance between the unit and the cooking plane	Readjust the distance to 65-75 cm

ENVIRONMENTAL PROTECTION

Waste electrical products should not be disposed of with household waste. Please recycle where facilities exist. Check with your Local Authority or retailer for recycling advice.

This appliance is marked according to the European directive 2002/96/EC on Waste Electrical and Electronic Equipment (WEEE).

By ensuring this product is disposed of correctly, you will help prevent potential negative consequences for the environment and human health, which could otherwise be caused by inappropriate waste handling of this product.

The symbol on the product indicates that this product may not be treated as household waste. Instead it shall be handed over to the applicable collection point for the recycling of electrical and electronic equipment

Disposal must be carried out in accordance with local environmental regulations for waste disposal.

For more detailed information about treatment, recovery and recycling of this product, please contact your local city office, your household waste disposal service or the shop where you purchased the product.

Terms and Conditions:

1. This warranty is void if:
 - a. The completely filled warranty card is not presented at the time of servicing the product.
 - b. The product is not operated according to the instructions given under the user manual.
 - c. Damages are caused by lightning, abnormal voltage, water or other liquid intrusion, fire, flood, accident, negligence or improper handling.
 - d. Product has been damaged due to installation, repairs, alterations or modifications by unauthorized service organizations or persons.
 - e. Product label specifying the model number, serial number and production code has been removed and altered.
 - f. Defects or parts requiring replacement due to ordinary wear and tear, corrosion, rust or stains, scratches, dents on the casing or paintwork of the product.
 - g. Claims damaged and/or missing parts (accessories) after 7 days from the original date of goods received.
 - h. Defects or faults in product which have been used for commercial/industrial purposes or which have been rented/leased or have been otherwise subject to non-household/non-domestic use.
2. Repairs or replacements will be carried out by authorized service provider.
3. During the limited warranty period, Lifelong or its authorized service provider will repair without charge the defective unit inclusive of labor and parts and restore the unit to its optimum working condition. All defective parts used for the warranty repair should be surrendered to Lifelong and/or its authorised servicer.
4. All expenses incurred in collecting the unit (s) or part(s) thereof from authorised service provider as well as any other expenses and incidentals will be borne by the consumer.
5. Lifelong obligations are limited to the repair and replacement of the defective product. Except as set forth above, there are no other express or implied warranty and all warranted, conditions or other terms implied by statute or common law (including any warranty of satisfactory quality, merchantability or fitness for a particular purpose) are excluded to the fullest extent permitted by the law.
6. Lifelong total liability for damages relating to or arising out of the purchase or use of the product regardless of the type or cause of such damage of the form of characterization of the claim asserted (e.g. contract or tort) shall not exceed the original purchase price paid for the product.
7. However in no event shall Lifelong and Lifelong authorized distributors be liable for any punitive, special incidental, indirect or consequential losses or damages whatsoever (including without limitation, damages for the loss of revenue, business, profits, goodwill, or contracts, business interruptions, loss of business information or any other pecuniary loss.) Whether or not Lifelong has been advised of the possibility of such damages. These limitations shall apply not with standing the failure of the essential purpose of any limited warranty. This limited warranty does not affect consumer's statutory rights under the law.
8. No carrier, dealer or employee is thereof authorized to make modifications to this warranty and you should not rely on any such representation. Lifelong reserves the right to amend the terms and conditions if necessary.

Consumer Warranty Card

Dear Customer,

Thank you for choosing a Lifelong consumer product. All Lifelong Consumer products are designed and manufactured to the highest standards to deliver high quality performance, as well as easy installation and use. At Lifelong, we believe in providing not only service, but adding value to your purchase. The warranty has therefore been designed especially for you with your interest at heart.

Warranty Service

All Lifelong consumer products are covered against manufacturing defects from them date of purchase.

Name of the product: _____

Model: _____

Warranty coverage: 1 year

Please note: Purchase receipt is necessary for warranty verification.

Customer Care: customercare@lifelongonline.com

Customer Details

Name: _____

Address: _____

Home Number: _____

Office Number: _____

E-mail Address: _____

Product Details

Model No.: _____

Serial No.: _____

Purchase Date: _____

Invoice Number: _____

Online Site: _____

Please log on to www.lifelongindiaonline.com and complete the online warranty form with your personal and product details within 14 days.