

lifelong

MIXER GRINDERS

User Manual

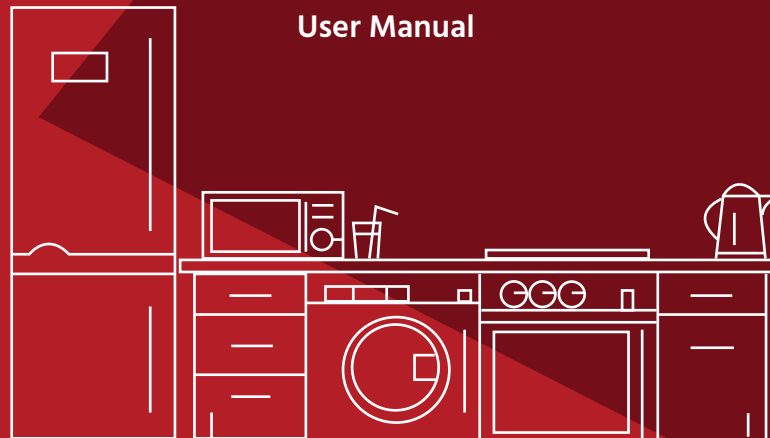

Manufactured for & Marketed by:
Lifelong Online Retail Private Limited

For queries and complaints:
please contact: customercare@lifelongindia.com
www.lifelongindiaonline.com

Built for Taste. Built for India.

INTRODUCTION:

Dear Customer, Congratulations!

We welcome you to the Lifelong family, as you welcome the Lifelong Nutri Mixer Grinder to be a part of your home.

At Lifelong, our products are carefully built for your needs, which is why we have crafted a diverse range of innovative products, across a spectrum of categories - Home, Kitchen, Grooming, Fitness, Lifestyle and Smart Home, to better help you. We then deliver them at the best prices, enriching your everyday living.

We are sure you can't wait to start using your new Lifelong Nutri Mixer Grinder.

We know we can't!

Looking forward to building our bond for life, cheers!

Thank you, Team Lifelong

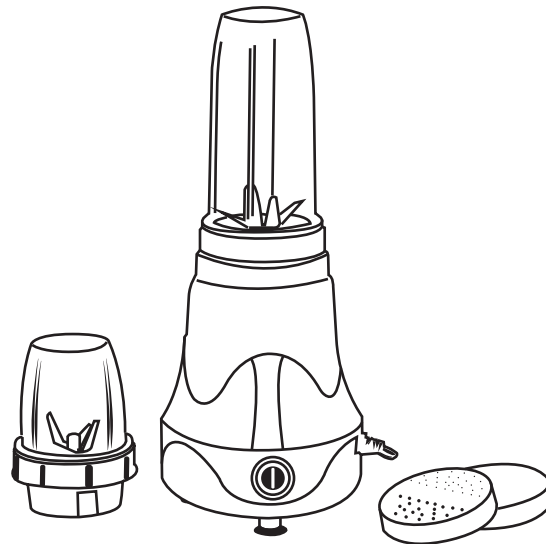

TABLE OF CONTENTS :

1. About the product
2. Marking of Product
3. Precautions Before Use
4. Device Operation
5. Overload protection
6. Device Cleaning
7. Terms and conditions
8. Warranty Card

ABOUT THE PRODUCT:

The Lifelong Nutri Blender is an essential addition to your kitchen and gives you excellent value for money. This durable multi-purpose Nutri blender is your go-to smoothie and juice maker. It extracts every ounce of immunity-enhancing antioxidants, pain-relieving Omega 3s, proteins, vitamins & minerals from your foods.

MARKING OF PRODUCT:

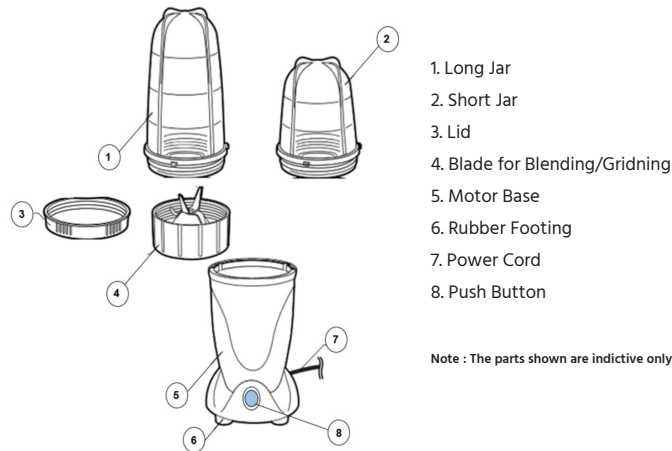

Note : The parts shown are indicative only.

PRECAUTIONS BEFORE USE:

1. Use the unit only as intended in this manual.
2. Make sure your electricity supply is 230V~50Hz.
3. To prevent from electrical shock, do not immerse the motor base and the cord set into water.
4. This is not a Toy; close supervision is required when the unit is used by or near children.
5. Ensure to unplug the unit when not in use, assembling or disassembling and before cleaning.
6. Blade is sharp, Handle with care.
7. Place the unit on a flat heat-resistant surface.
8. Do not place the unit near any explosive, heated oven, or hot surface.
9. Please hold the plug to disconnect from the power socket.
10. This unit is intended for household use only.
11. Do not use the unit outdoors or for other purpose than intended.
12. Do not run the unit continuously for longer than 1 minute at a time, give it a 3-minute break before using again for best performance.

Note: To avoid danger of electric shock, unplug the unit from outlet when not in use or before cleaning. If the supply cord is damaged, stop to use immediately and call customer care.

DEVICE OPERATION:

1. The unit is designed with a built-in safety system, If the jar is not securely locked into the motor base, the unit will not function.
2. The Nutri-Blend can be used for blending or grinding. You can use the unit with different modes as mentioned below (under the subheadings Blending and Grinding)
3. Plug the unit into a proper power socket at 230V~50Hz.

Blending

1. Put the prepared fruit into the long jar.
2. Cover the long jar with blade for blending/grinding. (Fig.1)
3. Put the jar onto the motor base, make sure the ledges of the jar are in correct position on two grooves of the motor base. (Fig.2)
4. Push down the jar and turn it clockwise to lock into the motor base (Fig.3) & press the push button (Fig.4) the unit start operating.
5. When the blending is completed, turn the jar anti-clockwise to release from the motor base (Fig.5), the operation will stop.
6. Take out the jar and open the blade holder, pour the blended juice into a container to serve.



Fig.1



Fig.2



Fig.3



Fig.4



Fig.5

Grinding

1. Put the prepared ingredient (e.g. Black pepper, Soya bean, sugar etc.) into the short jar.
2. Cover the short jar with the blade for blending/grinding. (Fig. 6)
3. Put the jar on to the motor base, make sure the ledges of the jar are in the correct position, on two grooves of the motor base. (Fig.7)
4. Push down the jar and turn it clockwise to lock into the motor base (Fig.8) & press the push button (Fig.9) to start the unit.
5. When the grinding is finished, turn the jar anti-clockwise to release it from the motor base (Fig.10) to stop its operation.
6. Detach the jar and open the blade holder, and pour the grinded mixture into a container.



Fig.6



Fig.7



Fig.8



Fig.9



Fig.10

OVERLOAD PROTECTION:

1. The overload protector (OLP) is designed to protect the motor from burning.
2. In case of an overload, the blade of the jar stops rotating and the motor gets jammed or starts heating up.
3. If such a situation occurs, the Nutri-blender will automatically turn off to protect the motor.
4. Let the motor cool down for a couple of minutes. The red button of the overload protector switch located at the bottom of the Nutri-blender must be pressed for re-operation.
5. If you must reset the OLP, try reducing the quantity of ingredients in the Jar.



Overload protector

DEVICE CLEANING:

1. Unplug the unit before cleaning.
2. Take off the jars and clean under the running water, rinse and then dry.
3. Do not immerse the motor base and power cord set into water, clean the motor base with a damp cloth and wipe it dry.



Terms and Conditions:

1. This warranty is void if:

- a. The completely filled warranty card is not presented at the time of servicing the product.
 - b. The product is not operated according to the instructions given under the user manual.
 - c. Damages are caused by lightning, abnormal voltage, water or other liquid intrusion, fire, flood, accident, negligence or improper handling.
 - d. Product has been damaged due to installation, repairs, alterations or modifications by unauthorized service organizations or persons.
 - e. Product label specifying the model number, serial number and production code has been removed and altered.
 - f. Defects or parts requiring replacement due to ordinary wear and tear, corrosion, rust or stains, scratches, dents on the casing or paintwork of the product.
 - g. Claims damaged and/or missing parts (accessories) after 7 days from the original date of goods received.
 - h. Defects or faults in product which have been used for commercial/industrial purposes or which have been rented/leased or have been otherwise subject to non-household/non-domestic use.
2. Repairs or replacements will be carried out by authorized service provider.
 3. During the limited warranty period, Lifelong or its authorized service provider will repair without charge the defective unit inclusive of labor and parts and restore the unit to its optimum working condition. All defective parts used for the warranty repair should be surrendered to Lifelong and/or its authorised servicer.
 4. All expenses incurred in collecting the unit (s) or part(s) thereof from authorised service provider as well as any other expenses and incidentals will be

5. Lifelong obligations are limited to the repair and replacement of the defective product. Except as set forth above, there are no other express or implied warranty and all warranted, conditions or other terms implied by statute or common law (including any warranty of satisfactory quality, merchantability or fitness for a particular purpose) are excluded to the fullest extent permitted by the law.
6. Lifelong total liability for damages relating to or arising out of the purchase or use of the product regardless of the type or cause of such damage of the form of characterization of the claim asserted (e.g. contract or tort) shall not exceed the original purchase price paid for the product.
7. However in no event shall Lifelong and Lifelong authorized distributors be liable for any punitive, special incidental, indirect or consequential losses or damages whatsoever (including without limitation, damages for the loss of revenue, business, profits, goodwill, or contracts, business interruptions, loss of business information or any other pecuniary loss.) Whether or not Lifelong has been advised of the possibility of such damages. These limitations shall apply not withstanding the failure of the essential purpose of any limited warranty. This limited warranty does not affect consumer's statutory rights under the law.
8. No carrier, dealer or employee is thereof authorized to make modifications to this warranty and you should not rely on any such representation. Lifelong reserves the right to amend the terms and conditions if necessary.

Consumer Warranty Card

Dear Customer,

Thank you for choosing a Lifelong consumer product. All Lifelong Consumer products are designed and manufactured to the highest standards to deliver high quality performance, as well as easy installation and use. At Lifelong, we believe in providing not only service, but adding value to your purchase. The warranty has therefore been designed especially for you with your interest at heart.

Warranty Service

All Lifelong consumer products are covered against manufacturing defects from their date of purchase.

Name of the product: _____

Model: _____

Warranty coverage: 1 year

Please note: Purchase receipt is necessary for warranty verification.

Customer Care: customercare@lifelongindia.com

Customer Details

Name: _____

Address: _____

Home Number: _____

Office Number: _____

E-mail Address: _____

Product Details

Model No.: _____

Serial No.: _____

Purchase Date: _____

Invoice Number: _____

Online Site: _____

Please log on to www.lifelongindiaonline.com and complete the online warranty form with your personal and product details within 14 days.