

Terms and Conditions:

1. This warranty is void if:
 - a. The completely filled warranty card is not presented at the time of servicing the product.
 - b. The product is not operated according to the instructions given under the user manual.
 - c. Damages are caused by lightning, abnormal voltage, water or other liquid intrusion, fire, flood, accident, negligence or improper handling.
 - d. Product has been damaged due to installation, repairs, alterations or modifications by unauthorized service organizations or persons.
 - e. Product label specifying the model number, serial number and production code has been removed and altered.
 - f. Defects or parts requiring replacement due to ordinary wear and tear, corrosion, rust or stains, scratches, dents on the casing or paintwork of the product.
 - g. Claims damaged and/or missing parts (accessories) after 7 days from the original date of goods received.
 - h. Defects or faults in product which have been used for commercial/industrial purposes or which have been rented/leased or have been otherwise subject to non-household/non-domestic use.
2. Repairs or replacements will be carried out by authorized service provider.
3. During the limited warranty period, Lifelong or its authorized service provider will repair without charge the defective unit inclusive of labor and parts and restore the unit to its optimum working condition. All defective parts used for the warranty repair should be surrendered to Lifelong and/or its authorised servicer.
4. All expenses incurred in collecting the unit (s) or part(s) thereof from authorised service provider as well as any other expenses and incidentals will be borne by the consumer.

5. Lifelong obligations are limited to the repair and replacement of the defective product. Except as set forth above, there are no other express or implied warranty and all warranted, conditions or other terms implied by statute or common law (including any warranty of satisfactory quality, merchantability or fitness for a particular purpose) are excluded to the fullest extent permitted by the law.
6. Lifelong total liability for damages relating to or arising out of the purchase or use of the product regardless of the type or cause of such damage of the form of characterization of the claim asserted (e.g. contract or tort) shall not exceed the original purchase price paid for the product.
7. However in no event shall Lifelong and Lifelong authorized distributors be liable for any punitive, special incidental, indirect or consequential losses or damages whatsoever (including without limitation, damages for the loss of revenue, business, profits, goodwill, or contracts, business interruptions, loss of business information or any other pecuniary loss.) Whether or not Lifelong has been advised of the possibility of such damages. These limitations shall apply not with standing the failure of the essential purpose of any limited warranty. This limited warranty does not affect consumer's statutory rights under the law.
8. No carrier, dealer or employee is thereof authorized to make modifications to this warranty and you should not reply on any such representation. Lifelong reserves the right to amend the terms and conditions if necessary.

Manufactured for & Marketed by :

Lifelong Online Retail Private Limited

For queries and complaints:
please contact: customercare@lifelongindia.com
www.lifelongindiaonline.com

Lifelong

HOME

MAKING IT POSSIBLE

4 Door Refrigerator

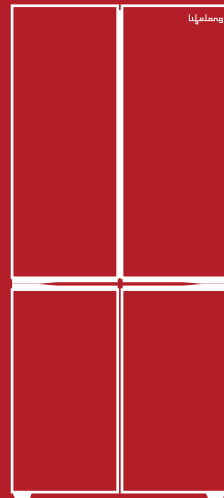

Electronic
Temperature
Control



Smart
Mode



Fast
Freezing



Holiday
Mode



Adjustable
Leg

1 YEAR
COMPREHENSIVE WARRANTY

10 YEAR
COMPRESSOR WARRANTY

Welcome to the Lifelong family

Dear Customer,
Congratulations on purchasing 4 Door refrigerator (500L) and a warm welcome to the Lifelong family.

At Lifelong, we take pride in developing quality products for your home, health and happiness. Through constant innovation in our products, we have been able to develop a wide spectrum of products across Home, Kitchen, Grooming and Wellness categories.

We strive to enrich the lives of the modern consumer every day. Keeping that in mind, we have offered all our products at a fair and honest price.

We hope that the Refrigerator serves you and your family's needs without any hassles. Thanks again for becoming a part of the Lifelong family. Enjoy using the product!

Warm Regards,
Team Lifelong

ABOUT THE PRODUCT

LIFELONG 4 Door Refrigerator allows you to maximize your storing space, with large freezer & refrigerator compartments. The all around cooling system, ensures that food in the refrigerator is cooled, evenly, in both fridge and freezer compartments. The Inverter Compressor saves energy. While the counter depth design, is seamless to blend well with your interiors, giving it a modern look.

SAFETY PRECAUTIONS

Please carefully read the following precautions before using.



- Keep the plug clean and firmly connected. Don't damage the power cord. Don't let the power cord be close to compressor to avoid failure of insulation.
- If the power cord is damaged, do not use it. Please get it replaced
- If there is gas leakage from compressor , close the gas valve & open the window for ventilation. Spark may generate if the power plug is immediately plugged out.
- Do not disassemble the refrigerator by yourself. Please contact service center.
- Plug out the power cord for cleaning, repairing or in case it is not used for a long time.



- If fluctuating electricity, abnormal sound, peculiar smell, smoke and other abnormalities are found during usage, immediately disconnect the power and stop using. Stop using refrigerator & contact service center.

- Don't use the refrigerator outdoor or expose it to rain.

- Never store the flammable, explosive and corrosive goods in the refrigerator. It isn't recommended to store the drugs and chemicals which have strict temperature requirement.

- If the light is blinking, don't dismantle by yourself. Contact service center.

- If the light is abnormal, don't dismantle by yourself. Contact the after-sales service center.

- If the supply cord is damaged, it must be replaced by the manufacturer, its service agent or similarly qualified persons in

- If the supply cord is damaged, it must be replaced by the manufacturer, its service agent or similarly qualified persons in order to avoid a hazard.

- This appliance can be used by children aged from 8 years and above if they have been given supervision or instruction concerning use of the appliance in a safe way and understand the hazards involved.

- Children shall not play with the appliance, cleaning and user maintenance shall not be made by children without supervision.

INTRODUCTION

REFRIGERATOR COMPONENTS

This figure is only schematic diagram. The actual product may be upgraded From time to time to improve the performance of the product.

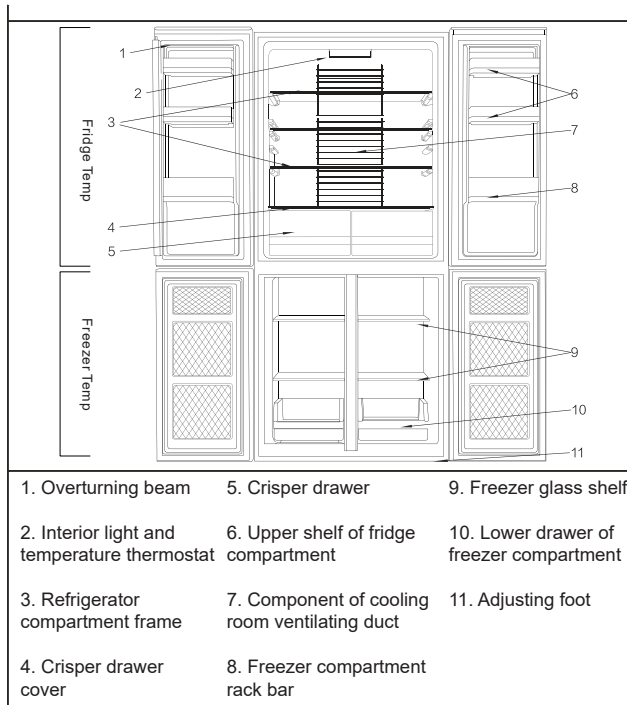

USAGE

PREPARATION

- Please use 220-240V/50HZ single-phase AC power supply and use the independent socket equipped with 10A fuse. If the refrigerator is used in a place with high humidity, connect the grounding wire and install the leakage protection switch. Don't lengthen the power cord. The socket shall be equipped with grounding wire.
 - Heavy items or container with water should not be placed on top of the refrigerator to avoid falling caused by vibration due to opening of the door.
 - Try not to install it in a place with high humidity because electricity leakage and rust may occur due to humidity.
 - The tilting angle of the refrigerator during moving shall not be higher than 45°.
 - The refrigerator shall not be installed outdoor or exposed to rain.
 - The refrigerator cannot be should not be installed near the gas, gasoline, alcohol, paint and other flammables. Those dangerous goods cannot should not be stored in the refrigerator.
 - The floor shall be flat and firm. Otherwise, noise and vibration may generate. If the floor isn't flat, properly adjust height of the adjusting foot.
 - If any abnormal smoke or sound occurs, immediately plug out the power plug and contact the after-sales service personnel.
 - After cutting power supply, the refrigerator may operate normally for at least 7 min. This measure is used to protect refrigerator from damage. Therefore, after disconnecting power supply, please wait at least 7 min to recover it.
 - At the beginning, the refrigerator may have slight peculiar smell which will disappear gradually.
- To avoid contamination of food, please respect the following instructions:
- Opening the door for long periods can cause a significant increase of the temperature in the compartments of the appliance.
 - Regularly clean surfaces that can come in contact with food and drainage systems.

- Clean water tanks if they have not been used for 48 h; flush the water system connected to a water supply if water has not been drawn for 5 days.
- Store raw meat and fish in suitable containers in the refrigerator, so that it is not in contact with or spills onto other food.
- Frozen-food compartments are suitable for storing pre-frozen food, storing or making ice-cream and making ice cubes.
- If the refrigerating appliance is left empty for long periods, switch off, defrost, clean, dry, and leave the door open to prevent smell developing within the appliance.

WARNING: When positioning the appliance, ensure the supply cord is not trapped or damaged.

WARNING: Do not put multiple portable socket-outlets or portable power supplies at the rear of the appliance.

WARNING: Food needs to be packed in bags before putting into the refrigerator, and liquids need to be packed in bottles or containers.

USAGE AND PRECAUTIONS OF DIFFERENT COMPARTMENTS

TIPS FOR USE OF REFRIGERATOR COMPARTMENT

1. The common refrigerating temperature of food stored in refrigerator is from 4°C to 8°C. In this environment, cooked meat can not be stored for more than 4 days, and fruits and vegetables should not exceed one week at most.
2. The common temperature of the chilling room is from -1 to 4°C, and meat can not be stored for more than 7 days.
3. Meat and seafood need to be packed in different containers and stored for not more than 3 days.
4. Raw food and cooked food need to be stored in different containers. In order to prevent bacterial contamination, raw vegetables and fruits should not be exposed to raw meat or fish. Vegetables and fruits should be wrapped by film and stored in the crisper.

5. Before freezing, the food should be, wrapped tightly with fresh-keeping film, and placed in different containers. The temperature of freezing room is - 18°C. Meat should be kept in fresh and fish in deep-frozen. In order to make the taste fresh and delicious, and to lock up the nutrition of food, the food in the refrigerator should not be stored for more than three months.

REFRIGERATOR HANDLING

- Plug the power plug out for disconnecting the power. Fix the plug on the body by adhesive tape to avoid it from dragging on the ground.
- All interiors shall be fixed by adhesive tape.
- Close the refrigerator door and fix by adhesive tape to avoid opening while moving.
- Move the refrigerator in tilted position. (The bottom is designed with the handle for

NOTICE

- Try to adjust the adjusting foots at bottom of refrigerator to the highest level (turn left) to avoid the bottom touching grounding during pushing.
- During handling, the refrigerator tilts backward, so residual water in the evaporating dish of machine chamber may spill out. Don't worry. Be careful to avoid dirtying and slipping the floor.
- It is prohibited to lay down the refrigerator. The tilting angle during handling shall not be more than 45°.
- After tilting handling, power on the refrigerator after at least 2 hours.



The refrigerator shall be placed in the ventilated place, avoid direct sunlight and keep it away from heat source. In addition, heat dissipation is required during operation, so a certain space shall be reserved around the refrigerator.

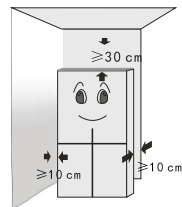

Enough space between refrigeration and wall

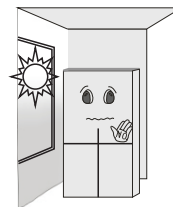

Avoid direct sunlight

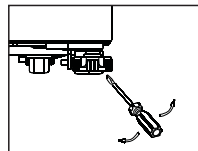

Turn left for refrigerator rising;
turn right for refrigerator downwards. It may be easier to adjust with slotted screwdriver.

- If the heavy bottles or foods are stored in the refrigerator, the left door and the right door may not be aligned. In such situation, adjust the door position again after 2 or 3 days after placement of the refrigerator.

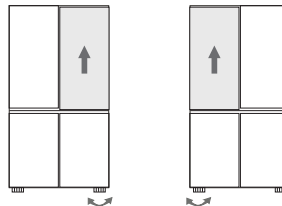

BUTTON INSTRUCTIONS

- The below picture is a schematic diagram of an electronic display.

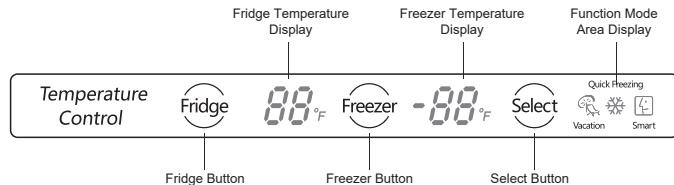

OPERATIONAL GUIDANCE OF DISPLAY

Button instruction

- “Fridge” button: Press this button to adjust the temperature of refrigerating chamber
- “Freeze” button: Press this button to adjust the temperature of freezing chamber
- “Select” button: With each click (within 5 seconds), the corresponding function icon flickers, and then switches among vacation or holiday mode - quick freezing- smart or intelligent mode successively (press down is effective).
- No operation within 5 seconds will end the operation.

- The LED display turns bright when the door is open. Push the “Fridge” button. The buzzer rings. Then the refrigerating room turns into the setting condition. The temperature patterns starts to flash and the temperature of the refrigerating room increases.

1. The temperature will vary as “01”—“02”—“03”—“04”—“05”—“06”—“07”—“——”—“01”. When the temperature turns “07”, push the “Fridge” button, then the refrigerator turns into the condition of pre-closing the refrigerating room and the LED display turns “——” with flashing light.

Warning: The temperature will be set successfully and the flash will disappear if setting is not done in 5 seconds.

The setting of the freezing room

- The LED display turns bright when the door is open. Push the ‘freezer’ button. The buzzer rings. Then the freezing room turns into the setting condition. The temperature flashes and the temperature of the freezing room increases by 1. It will move from “-15” to “-22”.

Warning: The temperature will be set successfully and the flash will disappear if setting is not done in 5 seconds.

The setting of the functions

- The LED display turns bright when the door is open. Push the “Select” button. Then it changes to setting functions.

- Entering the holiday or vacation mode: Push the “Select” button. **Flashing 5 times** When the holiday or vacation pattern turns bright, it is in the holiday or vacation mode.

- Exiting the holiday mode: Push the “Select” button. **Disappear** When the holiday pattern disappears, it is exiting the holiday mode.

- Note: In holiday or vacation mode, the temperature of cooling room is fixed at “-17°C”, and the temperature cannot not be regulated.

- Entering the quick freezing mode: Push the “Select” button. When the quick freezing pattern turns bright, it is in the quick freezing mode.

- Exiting the quick freezing mode: Push the “Select” button. **Disappear** When the quick freezing pattern disappears, it is exiting the quick freezing mode.

- Note: In quick freezing mode, the temperature of freezer room is fixed at low temperature, and it cannot be regulated. It will exit the quick freezing mode within 24 hours after finishing freezing.

- Entering the smart mode: Push the “Select” button. **Flashing 5 times** When the smart pattern turns bright, it is in the smart mode.

- Exiting the smart mode: Push the “Select” button. **Disappear** When the smart pattern disappears, it is exiting the smart mode.

Note: In the smart mode, the temperature of cooling room and freezer room change with the change of the environmental temperature and it regulates the temperature automatically.

Warning: Push the “Select” button, exit the smart mode, and all selected pattern disappear, then it exits the setting of modes. And will regulate the temperature automatically.

Warning: As for the holiday, quick freezing and smart modes, the refrigerator cannot work in two or three modes but only one mode.

Warning: The temperature of the refrigerating room cannot be regulated in holiday or smart mode; while the temperature of the freezing room cannot be regulated in smart or quick freezing mode.

LIGHTING AND ITS REPLACEMENT

- When the door of refrigerating chamber opens, the LED light turns on.
- When the lighting is damaged, please remove the lampshade first and then replace the LED lighting.
- The specific operations are shown in the following diagram:

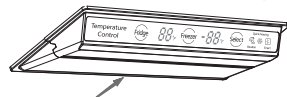

1. Please move the lampshade and the thermostat out 3-5mm in the direction of the arrow.

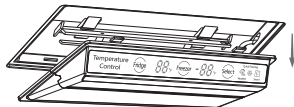

2. Take out the lamp shade and thermostat downwards the arrow.

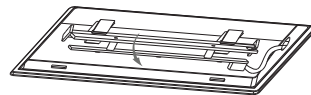

3. Pull the connection terminal, use the screwdriver to remove the LED light board and replace it.

Note: If the LED lamp is abnormal, it should be replaced by professionals. Do not dismantle and replace it yourself in order to avoid damage.

USE METHOD AND PRECAUTIONS OF DIFFERENT COMPARTMENTS

Fridge Temp

- The refrigerator compartment is mainly for storage of foods which are stored for short term.
- According to ambient temperature and setting temperature, temperature in the refrigerator compartment shall be maintained within 1°C~ 7°C . It cannot keep the food fresh in long term, but is only used for storage in short term.

Precautions for using refrigerator compartment

- The hot food shall not be placed in the refrigerator compartment before cooling.
- The food can be placed in different boxes by classification.
- The food with dirt and other foreign matters shall not be placed in the refrigerator compartment without cleaning to avoid contamination of the refrigerator.
- Wall of the refrigerator compartment is equipped with temperature sensor. Don't cover the sensor by foods.

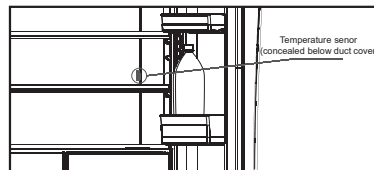

- Excessive food in the refrigerator may cause poor air circulation and keep temperature at a high value.
- Try to reduce the door opening and closing frequency.

USE METHOD AND PRECAUTIONS FOR EACH ROOM

Door Shelf , Bottle Shelf

- Disassembly:

1. Firstly, remove the left-side fixed clasp and firmly grasp the right side of the door shelf with your right hand. Press the left side of the door shelf with your left hand and then press towards the middle direction until the clasp is separated with the slot of door lining. Keep pressing and then pull outwards slowly until the door shelf gets rid of the clasp.

Once it gets rid of clasp, stop pulling outward.

2. Place the disassembled side away.

3. Remove the other clasp in the same way as above.

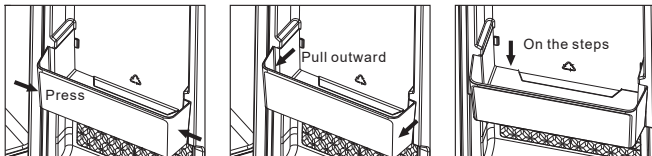

Installation

1. Press both sides to the middle position and parallelly push the door shelf into the step.
2. Press the inner side so that the clasp is fastened, and the side buckle is in the stop block.
3. Assemble both sides in the same way as above.

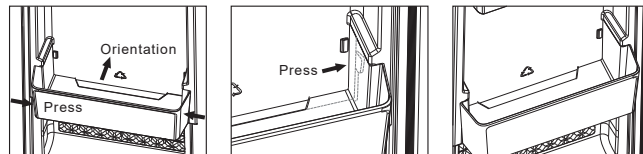

Overturning beam

- When the overturning beam is as shown in Figure 1, the door is unable to close normally, it must press the top guide block of the overturning beam as shown in Figure 2, firstly close the top guide block, then close the door. Prohibit turning the overturning beam to the state as shown in figure 1, otherwise the overturning beam may be damaged.

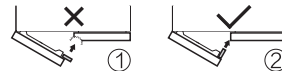

⚠ Notice: in order to prevent condensation, the overturning beam is provided with heater for heating. Overturning beam heating is normal phenomenon and has no effect on frozen food.

USE METHOD AND PRECAUTIONS OF DIFFERENT COMPARTMENTS

- Tips For Use Of Refrigerator Compartment

1. *Vegetables*

Potato--normal temperature preservation, please do not use cold storage (it may promote starch turn into sugar).

Potato shall be stored separately from other food(moisture and gas diffused from potato will speed up rotting); apple may prevent potato from sprouting when stored together.

Onion- Before peeling the onion, preserve it under normal temperature; after peeling it, put it into sealed container for cold storage.

Radish- Choose refrigerated preservation after removing soil and leaves (prevent nutrition from being absorbed by leaves).

Garlic, fresh ginger, water chestnut, rhizome, and radish store them at room temperature, do not choose cold storage (when room temperature is high, radish shall be firstly wrapped with paper before using cold storage).

Cucumber- Firstly wrap them with newspaper then apply cold storage.

Green pepper and pepper--Wash them with water and put them into sealed container or freshness protection package for storage.

Tomato--After they get squashy at room temperature, put them into refrigerator for cold storage.

2. *Fruits*

Watermelon - Uncut ones shall be stored at room temperature and cut ones shall be put in sealed container or plastic bag for preservation.

Banana and kiwi fruit -- They will get mature naturally amid normal temperature preservation and cold storage will make them soft rotten. Apple will accelerate their ripening when they are stored together.

Apple- Put them in plastic bag for cold storage (ethylene gas diffused by apple may accelerate metamorphism of other foods).

Pineapple- Use cold storage with root upward (root has the highest sugar content which may transmit downward).

Strawberry--Do not clean and do not remove stalk, directly put them into plastic bag for cold storage and eat them up within one week as far as possible.

(Strawberry stalk may evaporate and take away water content, put them in water no more than 3 seconds as far as possible when cleaning them).

Peach- Preserve them at room temperature, cold storage will reduce their sweetness.

Muskmelon and pawpaw store them at room temperature.

3. *Others*

Honey- Preserve them at room temperature, do not use cold storage (low temperature will make it solidify).

Bread- Preserve them at room temperature, do not choose cold storage (water loss will make them taste hard).

Coffee bean- Preserve them at room temperature, do not choose cold storage (foreign taste will cause them change flavor).

Salad dressing- Room temperature preservation (lipolysis during cold storage will make it easier to rot).

Olive oil- Preserve at room temperature (cold storage will make it freeze into butter shape).

Tofu put it in salt water and keep it in cold storage.

USE METHOD AND PRECAUTIONS OF DIFFERENT COMPARTMENTS

Freezer Temp

General use method of freezer compartment

- Low temperature of freezer compartment, it may store foods for long but not exceeding the valid period indicated on food package.

Precautions for use of freezer compartment

- Foods shall be packed separately or packed as per dosage per time and stored.
- There shall not be too much food stored in freezing drawer.
- Unfrozen food shall not be frozen repeatedly.
- Hot food must cool down to room temperature before being put into freezer compartment.
- Do not store bottled or canned foods.
- Do not put in liquid food contained in plastic bag.

- Glass bottles having alcoholic/ non-alcoholic aerated drinks shouldn't be left for more than sustainable hours in freezer. As there is likelihood of breakage and spill over.

▲ Notice: freezing will increase volume of liquid foods, therefore glass bottle including liquid food or sealed plastic bag packing foods may crack.

Energy saving method

- Refrigerator shall be installed at well-ventilated places far away from heat source as far as possible, and it shall be protected from direct sunshine.
- Reduce door opening/closing to avoid energy loss.
- Food shall be sorted and stored according to category so as to reduce the times of opening/closing door.
- Hot food shall be put in refrigerator only after it cools down.
- To ensure smooth air circulation, the refrigerator shall not be filled to the full by food.
- Food to be unfrozen may be firstly put in refrigerator compartment, which will prolong unfreezing time but is helpful to reduce temperature of the refrigerator compartment.

NON-FAULT PHENOMENON

- The heating of both sides of the cabinet and the frame around the door of freezing chamber: The heating will be obvious in starting and summer. This is the normal and there is no effect on the food in the cabinet.
- Long-term operation of compressor: When the refrigerator is first used, it takes a long time to work to reduce the temperature to a set value, and the compressor will run intermittently after the stable operation of refrigerator.
- Surface heating when the compressor is running: When the compressor works normally, the surface temperature is high, which is a normal phenomenon. Do not touch it with your hands.
- The sound of flowing water: It is a normal phenomenon for the sound of refrigerant flowing in the pipeline.

- Condensation of appearance: When the humidity of the surrounding of refrigerator is large, the condensation on the surface of the cabinet is a normal phenomenon.

- The sound of evaporator and piping: When the refrigerator runs, with changeable temperature, evaporator and pipe will make a sound due to thermal expansion and contraction.

- Overheat alarm of freezing room: It is caused by high temperature inside the cabinet for the first electrification. The alarm will be automatically cancelled when the temperature drops.

CLEANING

Cleaning method

- Please pull out power plug before cleaning.
- Take out all interior trim parts.
- Parts taken out shall be wiped with wet cloth dipped in neutral detergent, then washed with water, next wipe them dry with dry cloth and place them at ventilated place and wait for it to dry naturally.
- Use the same method to clean interior of the refrigerator.
- Door seal shall be firstly taken down and cleaned with neutral detergent and after getting dry in the air it shall be embedded into door again. Firstly fix the four corners..

Precautions for cleaning

- It is required to regularly clean refrigerator according to usage condition.
- Oil stains adhered onto door seal surface must be removed, otherwise door seal will harden, which will reduce refrigerator airtightness and result in temperature rise inside the compartment.
- It is forbidden to clean refrigerator with boiled water, gasoline, diluent, ethyl alcohol and other organic solvents. They will make plastic material surface deformation and cause fracture.

- Do not wash refrigerator with water directly so as to prevent rusting and electrical insulation reduction which may lead to electric shock..
- If refrigerator is to be left unused for long, please pull out power plug, and when closing refrigerator door after interior cleaning, ensure certain gap is reserved.
- Keep interior with smooth air circulation and place refrigerator at well-ventilated place.
- Refrigerator surface shall be wiped with soft cloth, do not use gasoline, diluent, ethyl alcohol or other organic solvent because they may cause damage to refrigerator surface.

Defrosting method

- This refrigerator is air-cooled, automatic defrosting product and requires no operation by users.
- Water produced after defrosting will flow into evaporation pan behind the refrigerator and evaporate there.

TROUBLESHOOTING

Problems and solutions

Problems	Reason analysis and solution
Refrigerator fails to work or has bad refrigerating effect, and control panel fails to display	<ul style="list-style-type: none"> - Check whether the power supply is connected. - Check if voltage is too low. - Check if socket is electrified. - Check if hot food items are stored in refrigerator. - If refrigerator is placed directly under sunshine, please move it to other place. - Whether there is heat dissipation space around the refrigerator. Please maintain enough space around the refrigerator.
Refrigerator exterior is hot (top, front face and two sides)	<ul style="list-style-type: none"> - Refrigerator interior is designed with condenser pipe for heat dissipation, this is normal phenomenon.
Refrigerator exterior is hot (top, front face and two sides)	<ul style="list-style-type: none"> - If refrigerator is near to heat source and has high ambient temperature, please move it to other place. - If door is closed or if door seal is fully sealed and has leakage point, it is a must to ensure that door is closed and door seal is well sealed.
There is water flow sound inside the refrigerator	<ul style="list-style-type: none"> - Flow of refrigerator's refrigerating fluid and defrosting water will make sound, this is normal.

Problems	Reason analysis and solution
There is abnormal noise amid refrigerator operation	<ul style="list-style-type: none"> - Check if refrigerator is placed at flat place and move it to flat places. - Whether articles producing noise are placed on top of refrigerator. - Check if the left and right of refrigerator is at the same level after installation, if not, please use adjusting foot to regulate refrigerator height.
There is peculiar smell inside the refrigerator	<ul style="list-style-type: none"> - Peculiar smell existing at initial use stage of refrigerator will disappear slowly; peculiar smell produced by interior pollution amid use shall be eliminated by regular cleaning. - Foods having strong flavor shall be well packed before storage.
There is condensation on refrigerator surface	<ul style="list-style-type: none"> - When refrigerator has high ambient moisture, condensation is normal, and it is only required to wipe it dry with cloth.
There is sound similar to "click" inside the refrigerator	<ul style="list-style-type: none"> - Such sound is caused by interior shrinkage or expansion of refrigerator and this phenomenon is normal.
Noise is large at early opening stage	<ul style="list-style-type: none"> - At opening stage large noise is normal, and noise will automatically reduce after stable running.
The refrigerating and freezing temperature display area of control panel fails to display digital but displays letter	<ul style="list-style-type: none"> - When it displays no digital but English letters, the refrigerator is suffering some damage, ask for after-sale maintenance as soon as possible even it may operate continuously.

▲ Notice: Refrigerating fluid and foaming agent left in refrigerator are combustibles, when maintaining the refrigerator, please contact specialized company for treatment so as to avoid fire disaster.

PRECAUTIONS FOR REFRIGERATOR OUT OF SERVICE

Use and precautions

Power outage

- For 2~3 h power outage, stored foods will not be significantly affected if refrigerator door is not opened.
- After power outage, please do not put in food, reduce door opening to the greatest extent
- If power outage is known in advance, prepare some ice cubes and put them in plastic bag or plastic case which shall be placed on top of freezer compartment and refrigerator compartment to help maintain refrigerator interior temperature.

Cease to use (refrigerator will be left unused for long)

1. Pull out power plug to disconnect power supply.
2. Take out food in refrigerator and clean the interior.
3. For long time storage, in order to prevent interior peculiar smell, please keep door slightly opened.

Notice

- After cutting power supply, the refrigerator may operate normally for at least 7 min. This measure is used to protect refrigerator from damage. Therefore, after disconnecting power supply, please wait at least 7 min to recover it.
- Please do not frequently open/close refrigerator, which may shorten refrigerator's life.
- When refrigerator suffers some damage and shall be scrapped, please contact special personnel for treatment. To avoid environment damage or leading to other hazard, do not discard it at will.

Reference

- For cleaning method applicable to long time storage, please refer to contents described in the column of "cleaning".

TECHNICAL PARAMETERS

Model		LL4DR500RG
Climate type		SN/N/ST/T
Anti-electric shock protection type		I
Fridge compartment volume (L)		335
Freezer compartment volume (L)		150
Freezing capacity (kg/24h)		10
Rated voltage (V)		220-240
Rated frequency (Hz)		50
Rated current (A)		1.6
Noise [dB (A)]		<42
Energy consumption (kW.h/24h)		0.85
Refrigerant type/ Refrigerant charge (g)		R600a/72
Net weight (kg)		89
Temperature of fridge compartment (°C)		1~7
Temperature of freezer compartment (°C)		-15~-22
Dimension	Width	825
	Depth	673
	Height	1903

PACKING LIST

Name		Pcs
Accessories Inside package	Upper shelf of fridge compartment	4
	Bottle shelf of fridge compartment	2
	Fridge compartment frame	2
	Crisper drawer cover	1
	Crisper drawer box	2
	freezer glass shelf	4
	Lower drawer of freezer compartment	2
Printing attachment	Instruction	1 copy

- We reserve the right to change parts of different models of refrigerators along with continuous research and improvement without further notice.

Consumer Warranty Card

Dear Customer,

Thank you for choosing a Lifelong consumer product. All Lifelong Consumer products are designed and manufactured to the highest standards to deliver high quality performance, as well as easy installation and use. At Lifelong, we believe in providing not only service, but adding value to your purchase. The warranty has therefore been designed especially for you with your interest at heart.

Warranty Service

All Lifelong consumer products are covered against manufacturing defects from their date of purchase.

Name of the product: _____

Model: _____

Warranty coverage: 1 year warranty on Product, 10 year warranty on Compressor

Please note: Purchase receipt is necessary for warranty verification.

Customer Care: customercare@lifelongindia.com

Customer Details

Name: _____

Address: _____

Home Number: _____

Office Number: _____

E-mail Address: _____

Product Details

Model No.: _____

Serial No.: _____

Purchase Date: _____

Invoice Number: _____

Online Site: _____

Please log onto to www.lifelongindiaonline.com and complete the online warranty form with your personal and product details within 14 days.