

Manufactured for & Marketed by :
Lifelong Online Retail Private Limited

For queries and complaints:
please contact: customercare@lifelongindia.com
www.lifelongindiaonline.com

lifelong

HIGH PRESSURE WASHER

User Manual

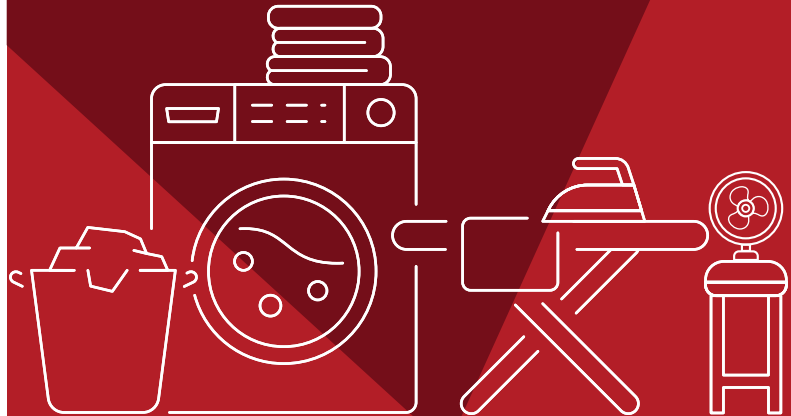

Built for Home. Built for India.

INTRODUCTION:

Dear Customer,

Congratulations! We welcome you to the Lifelong family, as you welcome our Lifelong Aquawash High Pressure Washer to be a part of your home.

At Lifelong, our products are carefully built for the needs of India, which is why we have crafted a diverse range of innovative products, across a spectrum of categories - Home, Kitchen, Grooming, Fitness, Lifestyle and Smart Home, to better help you. We then deliver them at the best prices, enriching your everyday living.

We are sure you can't wait to start using your new Lifelong Aquawash High Pressure Washer
We know we can't!

Looking forward to building our bond for life, cheers!
Thank you, Team Lifelong

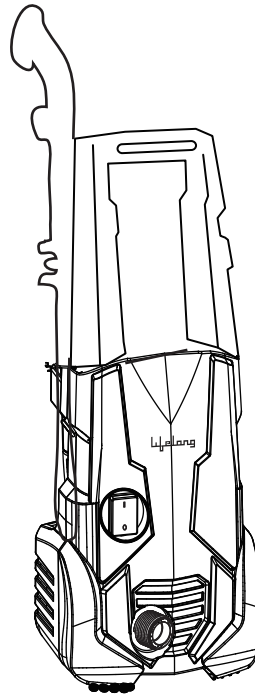

LLHPW19

TABLE OF CONTENTS:

1. About the Product
2. Marking of Product
3. Safety Precautions
4. Safety Symbols
5. Product Assembly
6. Technical Data
7. Device Maintenance & Storage
8. Troubleshooting Chart
9. Common Problems and Solutions
10. Terms and Conditions
11. Warranty

ABOUT THE PRODUCT:

The lifelong Aquawash High Pressure Washer is a helpful addition to your home that gives you great value for money. It's flexible and convenient, especially with the ergonomically designed carry handles and enabling to move anywhere you need. It's compact and lightweight, built easy to store, without occupying much space.

This high-pressure electric power washer is intended for residential use to clean vehicles, machines, buildings, facades etc.

MARKING OF PRODUCT:

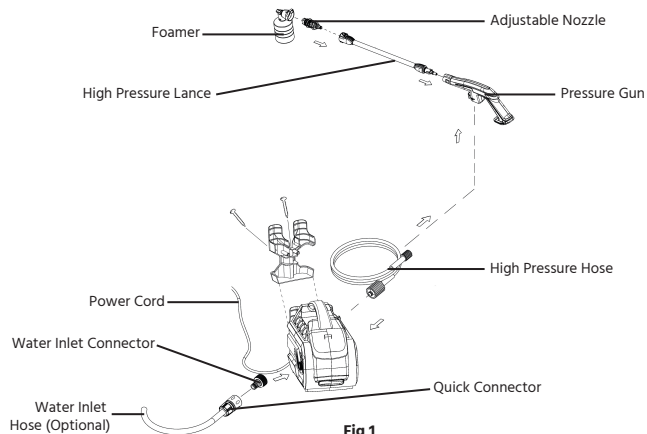

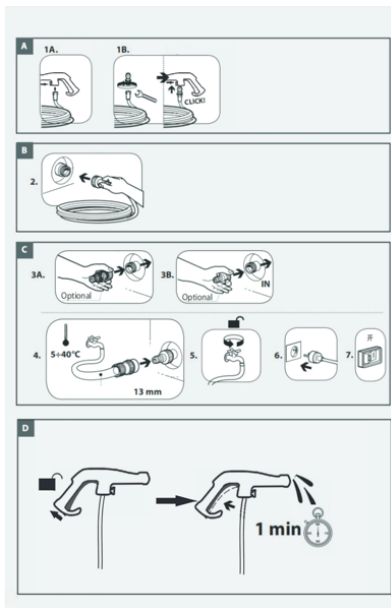

Fig 2

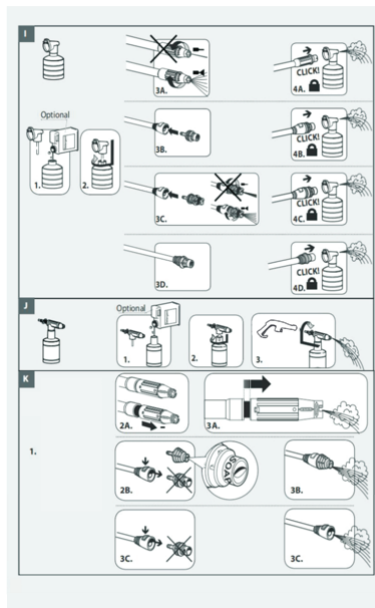

Fig 3

SAFETY PRECAUTIONS:

WARNING! This indicates a hazardous situation, which if not avoided, could result in death or serious injury.

GENERAL SAFETY:

WARNING! This appliance is not intended for use by children or by unassisted, unsupervised persons whose physical, sensory or mental capabilities prevent them from using it safely. Children should be supervised to ensure that they do not play with the appliance.

Before starting up your machine, please check it carefully for any defects. If you find any, do not start up your machine.

WARNING! When using the pressure washer, follow the basic safety precautions to reduce the risk of fire, electric shock, and personal injury.

- **Know your product:** Know how to stop the machine and bleed pressure quickly. Thoroughly familiarize yourself with the controls.
- **Keep bystanders away:** All visitors and pets should be kept a safe distance away from the work area.
- **Use the right product:** Do not use this machine for any job except that for which it is intended.

- **Dress Properly:** Do not wear loose clothing or jewellery. They can get caught in moving parts. Protective rubber gloves and non-slip footwear are recommended when working outdoors.
- Do not operate the pressure washer when you are tired, or under the influence of alcohol or drugs.
- Do not overreach: Keep proper footing and balance at all times.
- Do not abuse the cord: Never carry the machine by the cord or yank the cord to disconnect it from the receptacle. Keep the cord away from heat, oil, and sharp edges.
- Use safety glasses: Also use safety footwear, snug-fitting clothing, protective gloves, hearing and head protection.
- Check the water temperature: This pressure washer is not meant to pump hot water
- Never connect it to a hot water supply as it will significantly reduce the life of the pump.
- Store Indoors: Never store the pressure washer outdoors or where it could freeze. The pump could be seriously damaged.
- Inspect electrical cables: The insulation of the power cord should be perfectly intact. If the power cord is damaged or shows any signs of wear or tear, do not use the pressure washer.
- Risk of explosion: Do not spray flammable liquids.
- To ensure appliance safety, use only original replacement parts from the manufacturer or those approved by the manufacturer.
- Power cord connections should be kept dry and off the ground.
- If the power cord is damaged, do not use the appliance. Contact the seller.

- Keep the machine on a stable, flat surface during operation, handling, transportation and storage. Sudden overturn of the machine can cause bodily injury.
- In the event of an accident or breakdown, switch off the machine immediately. (If contact with detergent occurs, rinse with an abundance of clean water).
- Never use the machine in potentially explosive areas under any circumstances.
- The operating temperature must be between 0 C and 40 C.
- The machine consists of an assembly with a pump, which is encased in a shock absorbing housing. To provide the operator with an optional working position, the machine is equipped with a spray wand and a non-slip handle grip, whose shape and configuration comply with applicable regulations.
- Do not cover or modify the spray wand or the spray nozzles in any way.
- The high-pressure electric power washer is designed to be used with cold or lukewarm water; higher temperatures can damage the pump.
- **WARNING!** Do not use this appliance without reading this instruction manual.
- **WARNING!** This appliance has been designed for use with cleaning agents that are recommended by the manufacturer. The use of other cleaning agents or chemicals may adversely affect the safety of the appliance.
- **WARNING!** Do not use the appliance within range of persons unless they are wearing protective clothing.
- **WARNING!** High-pressure jets can be dangerous if subject to misuse. The jet must not be directed at persons, pets, live electrical equipment, or the appliance itself.
- **WARNING!** During cleaning, maintenance, or when replacing parts, the machine must be disconnected from its power source by removing the plug from the socket-outlet.

- **WARNING!** If an extension cord is used, the plug and socket must be of water weight construction.

- **WARNING!** Inadequate extension cords can be dangerous. This high-pressure electric power washer must not be used at temperature below 0 C.

Electrical Safety:

WARNING! ELECTRIC SHOCK HAZARD: Before starting your machine, please check it carefully for any defects. If you find any, do not start your machine and contact your distributor.

The following should be observed when connecting the high-pressure electric power washer to the electric supply:

- The electric supply connection should be performed by a qualified person.
- **IMPORTANT:** Only use water without any impurities. If there is a risk of running sand into the inlet water (i.e., from your own well), an additional filter should be installed.

Risk of electrocution:

- Inspect cord before using.
- Do not use if cord is damaged.
- Keep all connections dry and off the ground.
- Do not touch plug with wet hands.
- Keep cord away from heat and sharp edges.
- Do not spray electrical apparatus and wiring.

SAFETY SYMBOLS:

The following table depicts and describes safety symbols that may appear on this product. Read, understand and follow all instructions on the machine before attempting to assemble and operate.

Symbols	Descriptions	Symbols	Descriptions
	READ THE OPERATOR'S MANUAL(S) – Read, understand, and follow all instructions in the user manual(s) before attempting to assemble and operate.		WARNING! Electrical shock hazard.
	SAFETY ALERT – Indicates a precaution, a warning, or a danger.		WARNING! Do not expose the unit to rain or wet conditions. Keep dry.
	WEAR EYE AND HEARING PROTECTION – For protection against injury, wear ear defenders and safety goggles.		To reduce the risk of injury, user must keep all bystanders at least 49 ft (15 m) away.
	Wear safety gloves during use to protect hands.		Wear non-slip footwear that will protect your feet and improve your footing on slippery surfaces.
	Store indoors. Never store the pressure washer outdoors. If the pump freezes, permanent damage may result.		Machine not suitable for connection to the potable water mains.
	Always keep the power cable away from heat sources, oils, or sharp edges. Immediately remove plug from the mains if the cable is damaged, frayed, or entangled.		WARNING! Turn the machine OFF and disconnect it from the power supply before inspecting, cleaning, changing accessories, or conducting any other maintenance task.
	Sound power level is 92 dB(A).		Double Insulation – When servicing, use only identical replacement parts.

PRODUCT ASSEMBLY:

1. Position the washer as CLOSE as possible to the water supply.
2. The washer must be used on a secure and stable surface in a standing, upright position. (Fig. 1)

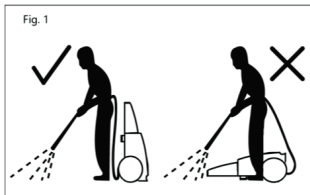

3. Fit the spray wand into the trigger gun and rotate it until the two parts are completely locked (Fig. 2)

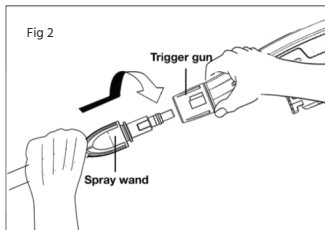

4. Connect the high-pressure hose to the trigger gun. (Fig. 3)

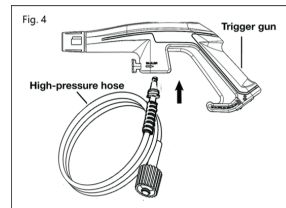

5. Connect the high-pressure hose to the water outlet on the washer. (Fig. 4)

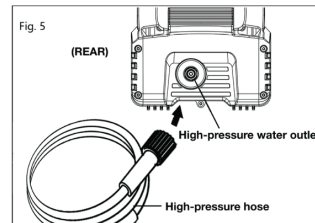

6. Connect the garden hose adaptor (female coupler) to the water inlet of the pressure washer, then thread your garden hose (male end) into the garden hose adaptor (Fig. 6). The garden hose must have an internal diameter of at least 13 mm (1/2 in.) and must be at least equal to the washer delivery capacity.

NOTE: The machine is not suitable for connection to the portable water main.

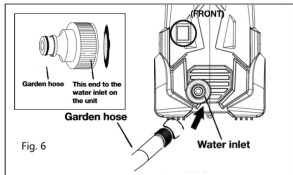

7. Attach Garden hose to water supply (Fig. 6)

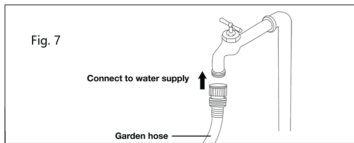

WARNING! The intake water temperature must not exceed 104 F/40 C. The water supply must not exceed 0.7 MPa.

CAUTION! The washer must only be used with clean water; use of unfiltered water containing corrosive chemicals will damage the washer.

8. Make sure the motor switch is pushed to the OFF (0) position before plugging the unit into the power outlet (Fig. 8).

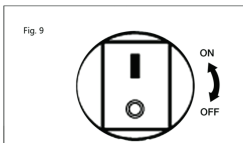

9. Snap the nozzle onto the Quick-Connect to disconnect a nozzle from the spray wand once the cleaning job is complete.

10. Turn off the pressure washer and shut off the water supply. Pull the trigger to release water pressure.

11. Remove the nozzle by placing your hand over the nozzle while pulling back on the Quick-Connect Collar.

WARNING! Do not make changes to the nozzle while the trigger is engaged. Doing so could result in damage to the pressure washer or injury to the user.

WORKING WITH DETERGENTS:

When cleaning with the pressure washer, some cleaning tasks can be solved with water alone, but for most tasks cleaning with detergent allows for more effective dirt removal.

WARNING! use only detergents specifically designed for use with pressure washers.

DO NOT USE household detergents, acids, alkaline solutions, bleaches, solvents, flammable material or industrial grade solutions. These could damage the pressure washer. Many detergents may require mixing prior to use. Prepare the cleaning solution as instructed on the solution bottle.

1. Fill each tank with detergent (Fig. 11 & 12)

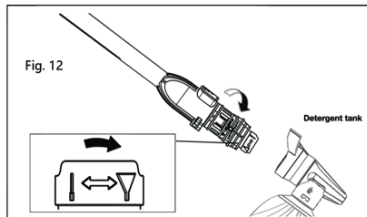
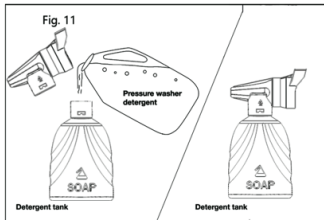

CAUTION! Always test the detergent in an inconspicuous area before use.

2. Turn on the pressure washer. Release the safety lock in the trigger before triggering as per the instructions given before. Pull the trigger to operate the unit.

The liquid detergent will automatically mix with water and be discharged through the nozzle.

3. Apply detergent from the bottom to the top of the dry surface to be cleaned.

NOTE: Wetting the surface first is not recommended as it dilutes the detergent and reduces its cleaning ability.

4. Allow the detergent to remain on the surface for a short time before rinsing.

Do not allow the detergent to dry on the surface.

CAUTION! Damage may occur to painted surfaces if the detergent is allowed to dry on the surface. Wash and rinse a small section at a time. Avoid working on hot surface or in direct sunlight.

5. When you have finished using the detergent injection system, remove the detergent suction tube from the detergent bottle and inset in into 0.3 L (0.08gal) of fresh water. Siphon water at low pressure for one minute so all the detergent is flushed through the system. Remove the detergent bottle and rinse it until it is thoroughly cleaned.

CAUTION! Failure to follow these cleaning instructions will cause the injection system to become clogged and inoperable.

Rinsing with the pressure washer

1. Turn off the pressure washer and shut off the water supply.
2. Pull the trigger to release water pressure.
3. Engage the safety lock on the trigger handle.
4. Select the right spray angle for the job by rotating the nozzle in any direction.

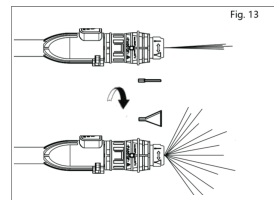

5. Start at the top of the area to be rinsed and work your way down, making sure to overlap your strokes.

IMPORTANT! NEVER USE:

- Bleach, chlorine products, and other corrosive chemicals.
- Liquids containing solvents (e.g., paint thinners, gasoline, oils)
- Tri-sodium phosphate products.
- Ammonia products.
- Acid-based products.

SHUTTING DOWN:

1. Turn the switch to the OFF (0) position and unplug the power cord from the outlet.
2. Turn off the water flow in the inlet water pipe.
3. Hold the trigger to release water pressure.
4. Disconnect the garden hose from the water inlet on the unit.
5. Disconnect the high-pressure hose connection on the trigger gun handle.
6. Release the trigger and engage the gun safety lock.

WARNING! Turn off the water supply and squeeze the trigger to depressurize the unit.

Failure to do so could result in personal injury due to discharge of high-pressure water.

SAFETY LOCK:

If you are taking a break of five minutes or more between cleaning tasks:

1. Engage the gun safety lock.
2. Turn the switch to the OFF (0) position.
3. Unplug the power cord from the outlet.

TECHNICAL DATA:

Rated Voltage	220-240V 50/60Hz
Wattage	1900 W
Max. Water Inlet Temperature	104°F/40°C
Max. Water Inlet Pressure	0.7 MPa
Rated Flow	4.5 L/Min
Max. Flow	6.5 L/Min
Working Pressure	80 Bar
Max. Pressure	120 Bar
Hose Length	5 m
Power Cord Length	5 m

DEVICE MAINTENANCE & STORAGE:

• Device Maintenance:

CAUTION! Before working on the pressure washer, disconnect the plug from the power supply socket.

1. To ensure good performance, check and clean the water inlet filter (fig. 14). Remove the filter and rinse with warm water to prevent any foreign matter from the clogging the pump.

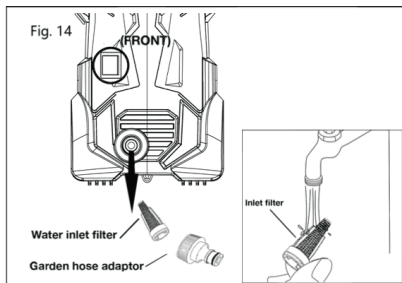

• Storage:

1. Store the pressure washer indoors in a dry, covered area where it is not subject to adverse weather conditions.
2. It is important to store this product in a frost-free area.
3. Always empty water from all hoses, the pump, and the detergent bottle before storing.

TROUBLESHOOTING CHART:

- Disconnect the unit from the electrical power supply before carrying out maintenance on the machine or when checking that its parts are in proper working order.
- To avoid unnecessary hassles, consult the following table before contacting customer service with any mechanical issues.

Problems	Possible Cause	Possible Solution
Pump does not reach working pressure	Nozzle worn	Replace nozzle
	Water filter fouled	Clean filter (fig. 5)
	Water supply pressure low	Turn on water supply tap fully
	Air being sucked into system	Check tightness of hose fittings
	Air in pump	Switch off the appliance and keep depressing and releasing the gun trigger until the water comes out in a steady flow. Switch the appliance back on again
	Adjustable nozzle not positioned correctly	Turn the adjustable nozzle (E) (+) (Fig. 3)
Pressure drops during use	Thermostatic valve tripped	Wait for correct water temperature to be restored
	Water intake from external tank	Connect appliance to the mains water supply
	Intake water too hot	Reduce temperature
	Nozzle clogged	Clean nozzle (fig. 5)
Motor "sounds" but fails to start	Intake filter (L) dirty	Clean filter (L) (fig. 5)
	Insufficient power supply	Check that the voltage of the mains power supply line is the same as that on the plate
	Voltage loss due to use of extension cable	Check characteristics of extension cable
	Appliance not used for a long period of time	Contact your nearest Authorized Service Center
Motor fails to start	Problems with TSS device	Contact your nearest Authorized Service Center
	Appliance not used for a long period of time	Using the tool (L) unjam the motor from the hole at the rear of the appliance (in models with this feature) (fig. 5)
	No electrical power	Check that the plug is firmly in the socket and that the mains voltage supply is present(*)
Water leakage	Seals worn	Have the seals replaced at your nearest Authorized Service Center
	Safety valve tripped and discharging	Contact an Authorized Service Center
Appliance noisy	Water too hot	Reduce temperature (see technical data)
Oil leakage	Seals worn	Contact your nearest Authorized Service Center
TSS versions only: motor start even with gun trigger is released	Nozzle clogged	Clean nozzle (fig. 5)
TSS versions only: no water delivery when gun trigger is depressed (with supply hose connected)	High pressure system or pump hydraulic circuit not water tight	Contact your nearest Authorized Service Center
No detergent taken in	Nozzle clogged	Clean nozzle (fig. 5)
	Adjustable nozzle on high pressure setting	Set nozzle on "-" setting (fig. 5)
	Detergent too dense	Dilute with water
	High pressure hose extension being used	Fit original hose
	Deposits or restriction in detergent circuit	Flush with clean water and eliminate any restrictions. If the problem persists, contact an Authorized Service Center

(*) If the motor starts and does not restart during operation, wait 2-3 minutes before repeating the start-up procedure (overload cutout has been tripped). If the problem recurs more than once, contact your nearest Authorized Service Centre.

COMMON PROBLEMS AND SOLUTIONS:

Low Nozzle Pressure

Low nozzle pressure is a common complaint. In a majority of instances, low nozzle pressure is generally caused by one of the following:

1. Obstructed or clogged nozzle tip.
2. Obstructed or clogged inlet filter.
3. Unloader valve stuck open due to debris lodged under the check valve ball.
4. Customer use of shutoff-type quick connectors.
5. Plugged or obstructed hose.
6. Insufficient flow in gallons per minute (not pressure) to the pump.

Why should I keep my nozzles clean?

Clogged nozzles can increase pump back pressure and possibly damage the pump.

Immediate attention is required.

How do I clean clogged nozzles?

1. Always disconnect your spray wand from the gun before cleaning your nozzles!
2. Clear the nozzle with a small rigid piece of wire such as a paper clip.
3. Flush the nozzle backwards with water.
4. Reconnect the wand to the gun.

5. Restart the pressure washer and depress the trigger on the spray gun. If the nozzle is still plugged or partially plugged, repeat number 1-4. If the previous procedure does not clear the nozzle, replace with a new nozzle.

Surging Operation

Another condition is that pressure surges. That is, when the trigger is pulled, pressure is satisfactory for a moment then falls off. When the trigger is released, pressure builds up to normal levels. This is generally a sign that the water supply cannot provide the flow rate (gallons per minute) required by the pump. Following are some possible solutions:

1. Make sure the supply is not restricted; that there are no under-sized fittings and the inlet screen is unobstructed.
2. Make sure the flow rate of the water supply is sufficient for the pump. First, find the capacity of your pump in gallons per minute (gpm). Then determine the flow rate of your supply by measuring the gallons that can be delivered in one minute. If your supply does not deliver the gpm your pump requires, do not use the pump. It will suck air, causing cavitations which can quickly damage pump components.
3. Check for leaks in the supply fittings. Any leak will cause the pump to draw air and perform poorly.

Terms and Conditions:

1. This warranty is void if:
 - a. The completely filled warranty card is not presented at the time of servicing the product.
 - b. The product is not operated according to the instructions given under the user manual.
 - c. Damages are caused by lightning, abnormal voltage, water or other liquid intrusion, fire, flood, accident, negligence or improper handling.
2. Product has been damaged due to installation, repairs, alterations or modifications by unauthorized service organizations or persons.
3. Product label specifying the model number, serial number and production code has been removed and altered.
4. Defects or parts requiring replacement due to ordinary wear and tear, corrosion, rust or stains, scratches, dents on the casing or paintwork of the product.
5. Claims damaged and/or missing parts (accessories) after 7 days from the original date of goods received.
6. Defects or faults in product which have been used for commercial/industrial purposes or which have been rented/leased or have been otherwise subject to non-household/non-domestic use.
7. Repairs or replacements will be carried out by authorized service provider.
8. During the limited warranty period, Lifelong or its authorized service provider will repair without charge the defective unit inclusive of labor and parts and restore the unit to its optimum working condition. All defective parts used for the warranty repair should be surrendered to Lifelong and/or its authorised servicer.
9. All expenses incurred in collecting the unit (s) or part(s) thereof from authorised service provider as will as any other expenses and incidentals will be borne by the consumer.

5. Lifelong obligations are limited to the repair and replacement of the defective product. Except as set forth above, there are no other express or implied warranty and all warranted, conditions or other terms implied by statute or common law (including any warranty of satisfactory quality, merchantability or fitness for a particular purpose) are excluded to the fullest extent permitted by the law.
6. Lifelong total liability for damages relating to or arising out of the purchase or use of the product regardless of the type or cause of such damage of the form of characterization of the claim asserted (e.g. contract or tort) shall not exceed the original purchase price paid for the product.
7. However in no event shall Lifelong and Lifelong authorized distributors be liable for any punitive, special incidental, indirect or consequential losses or damages whatsoever (including without limitation, damages for the loss of revenue, business, profits, goodwill, or contracts, business interruptions, loss of business information or any other pecuniary loss.) Whether or not Lifelong has been advised of the possibility of such damages. These limitations shall apply not with standing the failure of the essential purpose of any limited warranty. This limited warranty does not affect consumer's statutory rights under the law.
8. No carrier, dealer or employee is thereof authorized to make modifications to this warranty and you should not rely on any such representation. Lifelong reserves the right to amend the terms and conditions if necessary.

Consumer Warranty Card

Dear Customer,

Thank you for choosing a Lifelong consumer product. All Lifelong Consumer products are designed and manufactured to the highest standards to deliver high quality performance, as well as easy installation and use. At Lifelong, we believe in providing not only service, but adding value to your purchase. The warranty has therefore been designed especially for you with your interest at heart.

Warranty Service

All Lifelong consumer products are covered against manufacturing defects from their date of purchase.

Name of the product: _____

Model: _____

Warranty coverage: 1 year

Please note: Purchase receipt is necessary for warranty verification.

Customer Care: customercare@lifelongindia.com

Customer Details

Name: _____

Address: _____

Home Number: _____

Office Number: _____

E-mail Address: _____

Product Details

Model No.: _____

Serial No.: _____

Purchase Date: _____

Invoice Number: _____

Online Site: _____

Please log on to www.lifelongindiaonline.com and complete the online warranty form with your personal and product details within 14 days.