

Wanglong

HOME

MAKING IT POSSIBLE

Car Vaccuum Cleaner

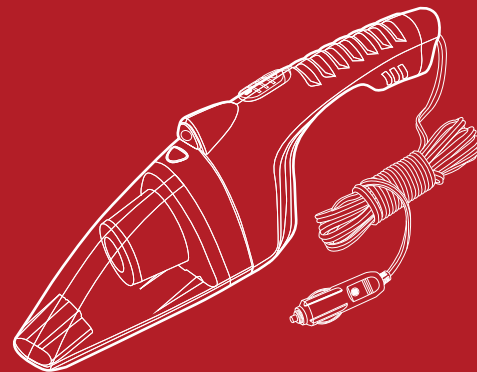

Easy To
Use



Wet/dry cleaning
application



Double Filtration
System

1 YEAR
WARRANTY

INTRODUCTION

Dear Customer,

Congratulations on purchasing Lifelong Car Vacuum Cleaner and a warm welcome to the Lifelong family.

At Lifelong, we take pride in developing quality products for your home, health and happiness. Through constant innovation in our products, we have been able to develop a wide spectrum of products across Home, Kitchen, Grooming and Wellness categories. We strive to enrich the lives of the modern consumer every day. Keeping that in mind, we have offered all our products at a fair and honest price.

We hope that the Car Vacuum Cleaner serves you and your family's needs without any hassles.

Thanks again for becoming a part of the Lifelong family. Enjoy using the product!

Warm Regards,
Team Lifelong

PRODUCT PROFILE

The cleaner product is designed for automobiles with 12 V supply. It adopts high-efficiency HEPA filter system that has unique rapid cleaning design and convenient usage. No need to worry about getting hands dirty. With the help of the cleaner, any tiny particles of dust and dry scraps in the space can be removed quickly.

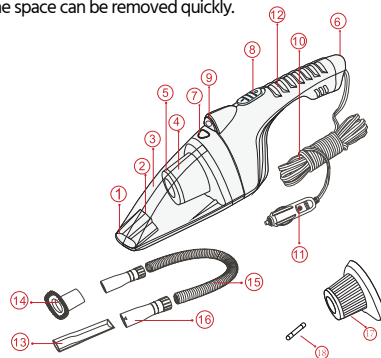

- | | |
|---|-------------------------|
| ① Suction Inlet | ② Garbage Check Valve |
| ③ Dust Collector | ④ Filter Cap |
| ⑤ HEPA Filter | ⑥ Heat Dissipating Port |
| ⑦ Dust Collector Lock | ⑧ Power Switch |
| ⑨ LED Light | ⑩ Power Cable |
| ⑪ Cigarette Lighter Plug
(Fuse built-in) | ⑫ Handle |
| ⑬ Flat Suction Nozzle | ⑭ Brush |
| ⑮ Extended Flexible Pipe | ⑯ Connector |
| ⑰ Spare HEPA Filter | ⑱ Spare Fuse |

PRODUCT PROFILE

1. Start engine and make sure the plug of cigar lighter is connected to the inside hole.
2. Turn on the switch over the handle and get ready for use.
3. Change suction nozzle for different occasions.
4. To get better effect, suction inlet is expected to lie flat on the ground while in use.
5. Please turn off switch timely and pull out the cigar lighter when you complete using.

NOTICE

1. Please make sure the cleaner is in service in accordance with specification under normal conditions.
2. Please don't use the cleaner without monitoring and shut off power if you don't use it.
3. Suck the following articles is strictly prohibited in case of damaged cleaner, fire or any accidents.

- (1) Hot objects, for example, cigarette butt, charcoal fire, etc.
- (2) Sharp fragments, for example, broken glass, etc.
- (3) Corrosive, aggressive solvent or liquid.
- (4) Combustible and explosive goods, for example, gasoline or alcohol products.
- (5) You don't need to repair the appliance or keep it lubricated. It is completely sealed in the production process. If you open it without permission, the cleaner may break down.

5. Don't drag the wire to lift up the cleaner.
6. Don't use the appliance outdoors on rainy days or under humid conditions.
7. To extend service life of cleaner, after continuously running for 20 minutes, you should let it take a 20-minute break and then switch it on.
8. Don't place the cleaner in the water and keep it away from hot appliances or blazing sun for a quite long time in case short circuit causes fire.

9. Don't allow children to play with or operate the cleaner to avoid accidents. Please avoid using this product outside in rainy days or humid environment. Wet & Dry Dual-use Vacuum Cleaner cannot be used to absorb a large amount of water. It can only be used to absorb dry substances with little water. To keep the suction ability, please periodically wash the filter net and dry it in a cool and shady place, and then the suction ability can be recovered. (Turn off the machine. Take out the front cover and pour out the water or liquid, and then put it back. It is forbidden to turn the machine upside down)

CLEAN STRAINER AND FILTER ELEMENT

If suction gets weak or service time is too long, you should clean the strainer and filter element of cleaner regularly to guarantee its performance.

ANALYSIS OF COMMON FAILURES

Failure	Possible Cause	Solution
Non-working cleaner	The power is turned off or plug gets loose.	Check the power or make sure power plug is connected tightly.
	The switch of cleaner is turned off.	Check if the switch is turned on.
	Fuse blowout	Screw on cigar lighter and change fuse
Weak suction	Thick dust on the strainer	Clean dust cup and strainer
	Low battery of accumulator	Charge up the battery with battery terminal or change accumulator
	The engine didn't run.	Start engine

MAINTENANCE AND REPAIR

1. It requires daily maintenance. Before maintenance and repair, please shut off the power first.
2. Regularly remove rubbish in the dust box for fear of any failures.
3. Instead of cleaning surface of cleaner with gasoline or oil, wash it with water or neutral detergent. Beware of water into electronic components, make sure you wing cotton towel before washing.
4. You shouldn't open the cleaner which is completely sealed in the production process without permission to prevent against possible breakdown of the appliance.
5. All repair services shall be performed by manufacturers or authorized agencies.

Message to our customers:

Before you use products, please read instruction for use carefully and keep it with due care.

Terms and Conditions:

1. This warranty is void if:
 - a. The completely filled warranty card is not presented at the time of servicing the product.
 - b. The product is not operated according to the instructions given under the user manual.
 - c. Damages are caused by lightning, abnormal voltage, water or other liquid intrusion, fire, flood, accident, negligence or improper handling.
 - d. Product has been damaged due to installation, repairs, alterations or modifications by unauthorized service organizations or persons.
 - e. Product label specifying the model number, serial number and production code has been removed and altered.
 - f. Defects or parts requiring replacement due to ordinary wear and tear, corrosion, rust or stains, scratches, dents on the casing or paintwork of the product.
 - g. Claims damaged and/or missing parts (accessories) after 7 days from the original date of goods received.
 - h. Defects or faults in product which have been used for commercial/industrial purposes or which have been rented/leased or have been otherwise subject to non-household/non-domestic use.
2. Repairs or replacements will be carried out by authorized service provider.
3. During the limited warranty period, Lifelong or its authorized service provider will repair without charge the defective unit inclusive of labor and parts and restore the unit to its optimum working condition. All defective parts used for the warranty repair should be surrendered to Lifelong and/or its authorised servicer.
4. All expenses incurred in collecting the unit (s) or part(s) thereof from authorised service provider as will as any other expenses and incidentals will be borne by the consumer.
5. Lifelong obligations are limited to the repair and replacement of the defective product. Except as set forth above, there are no other express or implied warranty and all warranted, conditions or other terms implied by statute or common law (including any warranty of satisfactory quality, merchantability or fitness for a particular purpose) are excluded to the fullest extent permitted by the law.
6. Lifelong total liability for damages relating to or arising out of the purchase or use of the product regardless of the type or cause of such damage of the form of characterization of the claim asserted (e.g. contract or tort) shall not exceed the original purchase price paid for the product.
7. However in no event shall Lifelong and Lifelong authorized distributors be liable for any punitive, special incidental, indirect or consequential losses or damages whatsoever (including without limitation, damages for the loss of revenue, business, profits, goodwill, or contracts, business interruptions, loss of business information or any other pecuniary loss.) Whether or not Lifelong has been advised of the possibility of such damages. These limitations shall apply not with standing the failure of the essential purpose of any limited warranty. This limited warranty does not affect consumer's statutory rights under the law.
8. No carrier, dealer or employee is thereof authorized to make modifications to this warranty and you should not rely on any such representation. Lifelong reserves the right to amend the terms and conditions if necessary.

Manufactured for & Marketed by :

Lifelong Online Retail Private Limited

For queries and complaints:
please contact: customercare@lifelongindia.com
www.lifelongindiaonline.com

Consumer Warranty Card

Dear Customer,

Thank you for choosing a Lifelong consumer product. All Lifelong Consumer products are designed and manufactured to the highest standards to deliver high quality performance, as well as easy installation and use. At Lifelong, we believe in providing not only service, but adding value to your purchase. The warranty has therefore been designed especially for you with your interest at heart.

Warranty Service

All Lifelong consumer products are covered against manufacturing defects from their date of purchase.

Name of the product: _____

Model: _____

Warranty coverage: 1 Year

Please note: Purchase receipt is necessary for warranty verification.

Customer Care: customercare@lifelongindia.com

Customer Details

Name: _____

Address: _____

Home Number: _____

Office Number: _____

E-mail Address: _____

Product Details

Model No.: _____

Serial No.: _____

Purchase Date: _____

Invoice Number: _____

Online Site: _____

Please log onto to www.lifelongindiaonline.com and complete the online warranty form with your personal and product details within 14 days.