

Lifelong

HOME

MAKING IT POSSIBLE

Lifelong Pedestal Fan

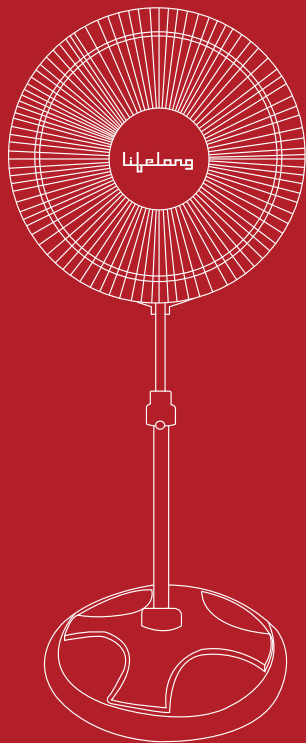

Total Sweep
Length 400mm



High RPM
1900



Aerodynamically
Designed Blades



3-Speed
Options

**1 YEAR
WARRANTY**

ASSEMBLY INSTRUCTION

1. Take out Motor with Switch Assembly Base/ Outer Tube.
2. Locate the Outer Tube (13) on the Base (15} and tighten with 4 nos Screw & Nut Provided.
3. Slidedown the Base Canopy (14) on the Outer Tube (13) by unscrewing the Height Adjustment Collet (12) after placing the Canopy Screw the Height Adjustment Collect (12) back in position.
4. Place Motor with Switch Assembly on the Inner Tube (11) and tighten it with the Knob screw (10) and adjust the height as per requirement by Height Adjustment Collect (12).
5. Unscrew Lock-Nuts(2) & (4) from the Motor Shaft & from The Front Cowl (7).
6. Fix Back Guard (5) and tighten with front Cowl Nut (4).
7. Slide the Plastic Blade on the Motor Shaft tighten the Blade with Lock Nut (2) by rotating it in the anticlockwise direction.
8. Place the Front Guard (1) and align the Plastic Ring with Front and Back Guard and tighten the Plastic Ring Screw.
9. The Oscillation mechanism can be activated by pushing the Oscillatory. Knob (6) downward and the fan can be made to stationary position by gently pulling the Oscillatory. knob (6).
10. The Speed of the fan can be regulated by speed Control Switch (9) fitted on the Switch Box (8) by pressing the relevant buttons.

0- Stop, 1-Low, 2-Medium, 3-High

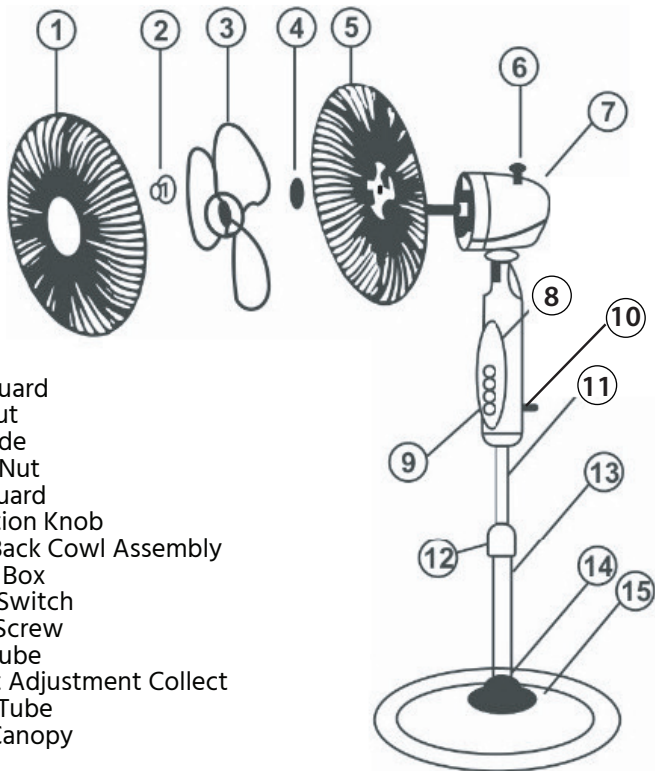

1. Front Guard
2. Lock Nut
3. Fan Blade
4. Plastic Nut
5. Back Guard
6. Oscillation Knob
7. Front/Back Cowl Assembly
8. Switch Box
9. Speed Switch
10. Knob Screw
11. Inner Tube
12. Height Adjustment Collect
13. Outer Tube
14. Base Canopy
15. Base

OPERATIONS

Plug in 220/240V, 50 Hz. AC Supply. Index the guard for the desired direction of oscillation or still position.

CLEANING

Wipe gently with a damp cloth for cleaning. Occasional wax polishing helps to retain the original lustre.

CAUTION

Do not bump the guard or blades against anything. The Deformation of the angles of the blades is liable to cause malfunction. When removing or carrying the fan be sure to take hold of the handle or stand. Do not pull any of the exterior electric wires & tilt or index the fan when in operation.

Consumer Warranty Card

Dear Customer,

Thank you for choosing a Lifelong consumer product. All Lifelong Consumer products are designed and manufactured to the highest standards to deliver high quality performance, as well as easy installation and use. At Lifelong, we believe in providing not only service, but adding value to your purchase. The warranty has therefore been designed especially for you with your interest at heart.

Warranty Service

All Lifelong consumer products are covered against manufacturing defects from their date of purchase.

Name of the product: _____

Model: _____

Warranty coverage: 1 year

Please note: Purchase receipt is necessary for warranty verification.

Customer Care: customercare@lifelongindia.com

Customer Details

Name: _____

Address: _____

Home Number: _____

Office Number: _____

E-mail Address: _____

Product Details

Model No.: _____

Serial No.: _____

Purchase Date: _____

Invoice Number: _____

Online Site: _____

Please log onto to www.lifelongindiaonline.com and complete the online warranty form with your personal and product details within 14 days.

Terms and Conditions:

1. This warranty is void if:

- a. The completely filled warranty card is not presented at the time of servicing the product.
 - b. The product is not operated according to the instructions given under the user manual.
 - c. Damages are caused by lightning, abnormal voltage, water or other liquid intrusion, fire, flood, accident, negligence or improper handling.
 - d. Product has been damaged due to installation, repairs, alterations or modifications by unauthorized service organizations or persons.
 - e. Product label specifying the model number, serial number and production code has been removed and altered.
 - f. Defects or parts requiring replacement due to ordinary wear and tear, corrosion, rust or stains, scratches, dents on the casing or paintwork of the product.
 - g. Claims damaged and/or missing parts (accessories) after 7 days from the original date of goods received.
 - h. Defects or faults in product which have been used for commercial/industrial purposes or which have been rented/leased or have been otherwise subject to non-household/non-domestic use.
2. Repairs or replacements will be carried out by authorized service provider.
3. During the limited warranty period, Lifelong or its authorized service provider will repair without charge the defective unit inclusive of labor and parts and restore the unit to its optimum working condition. All defective parts used for the warranty repair should be surrendered to Lifelong and/or its authorised servicer.
4. All expenses incurred in collecting the unit (s) or part(s) thereof from authorised service provider as well as any other expenses and incidentals will be borne by the consumer.

5. Lifelong obligations are limited to the repair and replacement of the defective product. Except as set forth above, there are no other express or implied warranty and all warranted, conditions or other terms implied by statute or common law (including any warranty of satisfactory quality, merchantability or fitness for a particular purpose) are excluded to the fullest extent permitted by the law.
6. Lifelong total liability for damages relating to or arising out of the purchase or use of the product regardless of the type or cause of such damage of the form of characterization of the claim asserted (e.g. contract or tort) shall not exceed the original purchase price paid for the product.
7. However in no event shall Lifelong and Lifelong authorized distributors be liable for any punitive, special incidental, indirect or consequential losses or damages whatsoever (including without limitation, damages for the loss of revenue, business, profits, goodwill, or contracts, business interruptions, loss of business information or any other pecuniary loss.) Whether or not Lifelong has been advised of the possibility of such damages. These limitations shall apply not with standing the failure of the essential purpose of any limited warranty. This limited warranty does not affect consumer's statutory rights under the law.
8. No carrier, dealer or employee is thereof authorized to make modifications to this warranty and you should not rely on any such representation. Lifelong reserves the right to amend the terms and conditions if necessary.

Manufactured Market by:
Lifelong Online Retail Private Limited

Made in India

For queries and complaints:
please contact: customer@lifelongindia.com
www.lifelongindiaonline.com