

Manufactured Market by:
Lifelong Online Retail Private Limited

For queries and complaints:
please contact: customercare@lifelongindia.com
www.lifelongindiaonline.com

Lifelong

Hot Water Bag



Free Washable
Cover



Usage Time Up to
120 minutes



5 To 10 Minutes
of Electric Charge



No Boiling
Sound

**1 YEAR
WARRANTY**

INTRODUCTION:

Dear Customer,

Congratulations! We welcome you to the Lifelong family, as you welcome our Lifelong Hot water bag to be a part of your home.

At Lifelong, our products are carefully built for the needs of India, which is why we have crafted a diverse range of innovative products, across a spectrum of categories - Home, Kitchen, Grooming, Fitness, Lifestyle and Smart Home, to better help you. We then deliver them at the best prices, enriching your everyday living.

We are sure you can't wait to start using your new Lifelong Hot water bag.

We know we can't!

Looking forward to building our bond for life, cheers!

Thank you, Team Lifelong

TABLE OF CONTENTS:

-About the product

-Marking on product

-How to use

-Device Cleaning

-Care Instructions

ABOUT THE PRODUCT:

Lifelong Hot water bag is a new way to reduce your time and stress. Unlike the traditional hot water bags, this hot water bag turns out to be far more effective in treating pains and general muscle cramps, apart from keeping your body warm in cold weather.

MARKING ON PRODUCT:

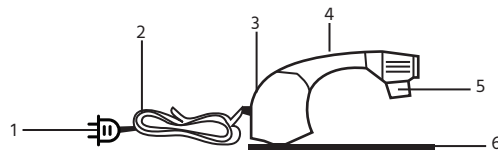

1. Plug
2. Power Cord
3. Power Supply
4. Movable Rod
5. Connector
6. Base Support

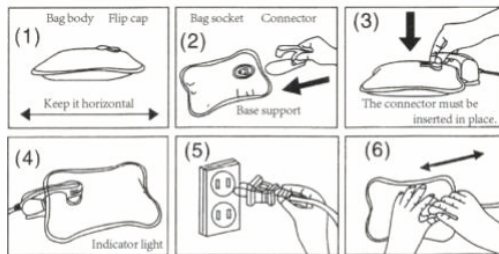

HOW TO USE:

1. Lay the bag on a flat surface, pull the flip cap up and insert the charger tray power under bag's body, align the connector to the socket on the bag, then press down the lever. Switch on and allow it to charge.
2. Charger is explosion proof and auto-cut's the supply after reaching maximum temperature.
3. Disconnect the power cable after turning off the power supply.
4. Close the flip cap and the bag is ready for use.
5. Bag also comes with a cover with hand insert option.

DEVICE CLEANING:

To clean the unplugged device after it has cooled down, wipe with a slightly damp cloth, and ensure that water doesn't get inside the device.

CARE INSTRUCTIONS:

1. Be sure to fully insert the connector into the socket on the bag, to avoid any risks.
2. If the power cord is damaged, please do not use other brand's wire. Kindly contact customer care support for further instructions.

3. Bag cover is washable, so can be washed in soft water and light detergent for hygiene purposes.

4. Please do not wash the bag.

5. Avoid children to operate the bag

6. Do not jump or place heavy external pressure on the bag.

7. Do not prick needle into the bag

8. Initially 2-3 times, you might experience some smell. This goes with every usage.

In case it is consistently coming or increasing, please switch off and unplug the device and report customer care for further instructions.

Consumer Warranty Card

Dear Customer,
Thank you for choosing a Lifelong consumer product. All Lifelong Consumer products are designed and manufactured to the highest standards to deliver high quality performance, as well as easy installation and use. At Lifelong, we believe in providing not only service, but adding value to your purchase. The warranty has therefore been designed especially for you with your interest at heart.

Warranty Service

All Lifelong consumer products are covered against manufacturing defects from their date of purchase.

Name of the product: _____

Model: _____

Warranty coverage: 1 year

Please note: Purchase receipt is necessary for warranty verification.

Customer Care: customercare@lifelongindia.com

Customer Details

Name: _____

Address: _____

Home Number: _____

Office Number: _____

E-mail Address: _____

Product Details

Model No.: _____

Serial No.: _____

Purchase Date: _____

Invoice Number: _____

Online Site: _____

Please log onto to www.lifelongindiaonline.com and complete the online warranty form with your personal and product details within 14 days.

Terms and Conditions:

1.This warranty is void if:

- a. The completely filled warranty card is not presented at the time of servicing the product.
 - b. The product is not operated according to the instructions given under the user manual.
 - c. Damages are caused by lightning, abnormal voltage, water or other liquid intrusion, fire, flood, accident, negligence or improper handling.
 - d. Product has been damaged due to installation, repairs, alterations or modifications by unauthorized service organizations or persons.
 - e. Product label specifying the model number, serial number and production code has been removed and altered.
 - f. Defects or parts requiring replacement due to ordinary wear and tear, corrosion, rust or stains, scratches, dents on the casing or paintwork of the product.
 - g. Claims damaged and/or missing parts (accessories) after 7 days from the original date of goods received.
 - h. Defects or faults in product which have been used for commercial/industrial purposes or which have been rented/leased or have been otherwise subject to non-household/non-domestic use.
2. Repairs or replacements will be carried out by authorized service provider.
3. During the limited warranty period, Lifelong or its authorized service provider will repair without charge the defective unit inclusive of labor and parts and restore the unit to its optimum working condition. All defective parts used for the warranty repair should be surrendered to Lifelong and/or its authorised servicer.
4. All expenses incurred in collecting the unit (s) or part(s) thereof from authorised service provider as well as any other expenses and incidentals will be borne by the consumer.

5. Lifelong obligations are limited to the repair and replacement of the defective product. Except as set forth above, there are no other express or implied warranty and all warranted, conditions or other terms implied by statute or common law (including any warranty of satisfactory quality, merchantability or fitness for a particular purpose) are excluded to the fullest extent permitted by the law.
6. Lifelong total liability for damages relating to or arising out of the purchase or use of the product regardless of the type or cause of such damage of the form of characterization of the claim asserted (e.g. contract or tort) shall not exceed the original purchase price paid for the product.
7. However in no event shall Lifelong and Lifelong authorized distributors be liable for any punitive, special incidental, indirect or consequential losses or damages whatsoever (including without limitation, damages for the loss of revenue, business, profits, goodwill, or contracts, business interruptions, loss of business information or any other pecuniary loss.) Whether or not Lifelong has been advised of the possibility of such damages. These limitations shall apply not withstanding the failure of the essential purpose of any limited warranty. This limited warranty does not affect consumer's statutory rights under the law.
8. No carrier, dealer or employee is thereof authorized to make modifications to this warranty and you should not rely on any such representation. Lifelong reserves the right to amend the terms and conditions if necessary.