

Lifelong

HOME

MAKING IT POSSIBLE

Lifelong
Aqua 6.5 Kg
Semi Automatic
Washing Machine

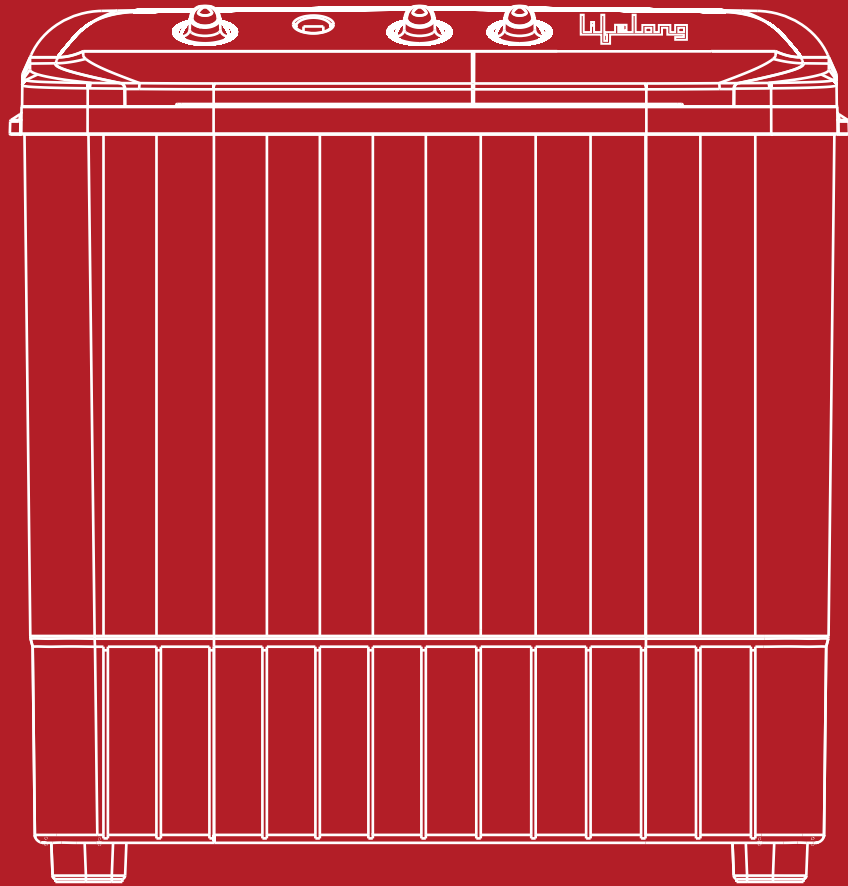

Buzzer



2 Wash Programs



Powerful
Motor



Anti-
Rust Body

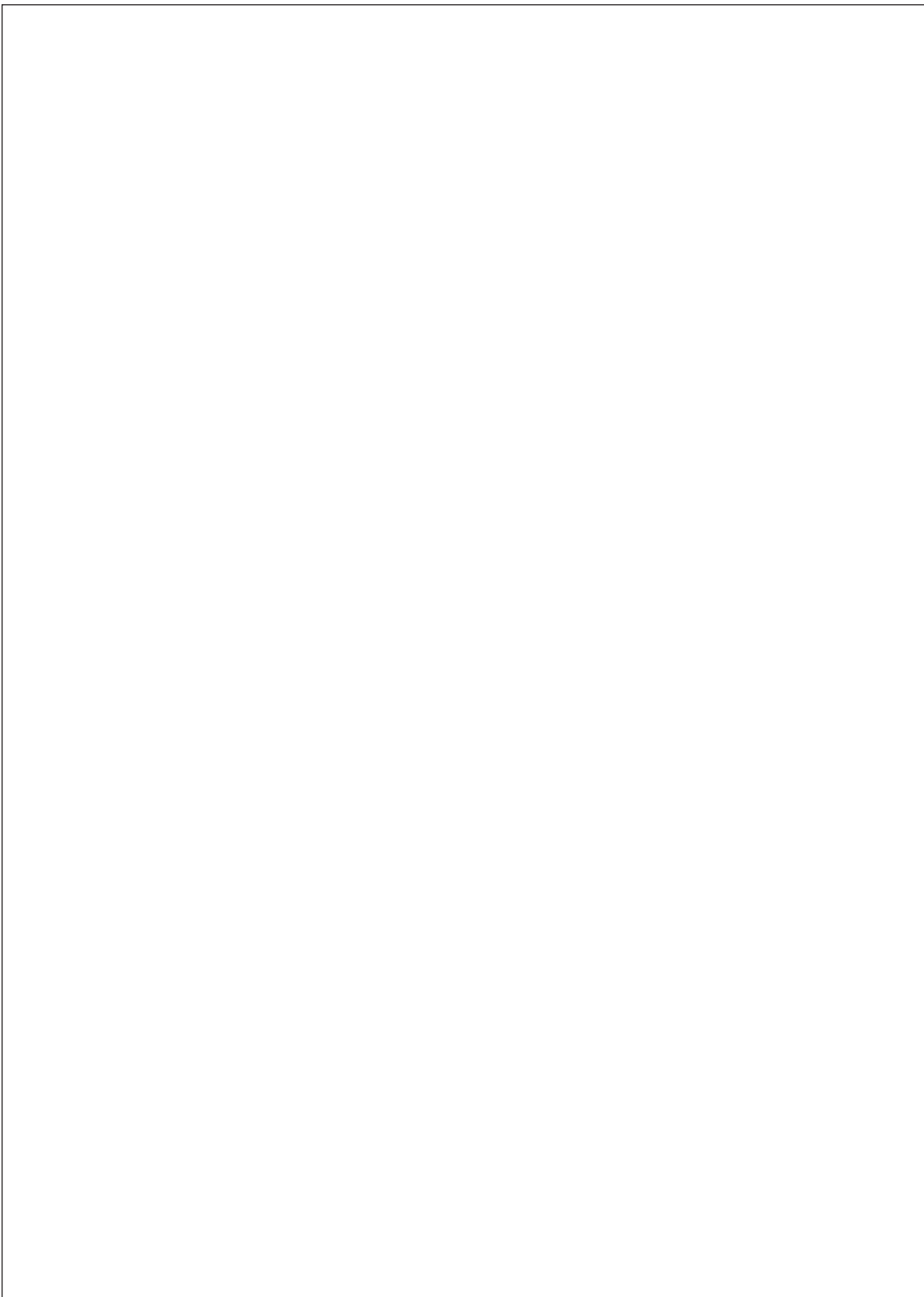

CONTENTS:

1.	Parts Identification	1
2.	Safety Precaution	2
3.	Care and maintenace.....	2
4.	Recommended Washing Procedure	3
5.	Laundry Guide	4
6.	Troubleshoot Table	5
7.	Specification & Wiring Diagram	6

PARTS IDENTIFICATION

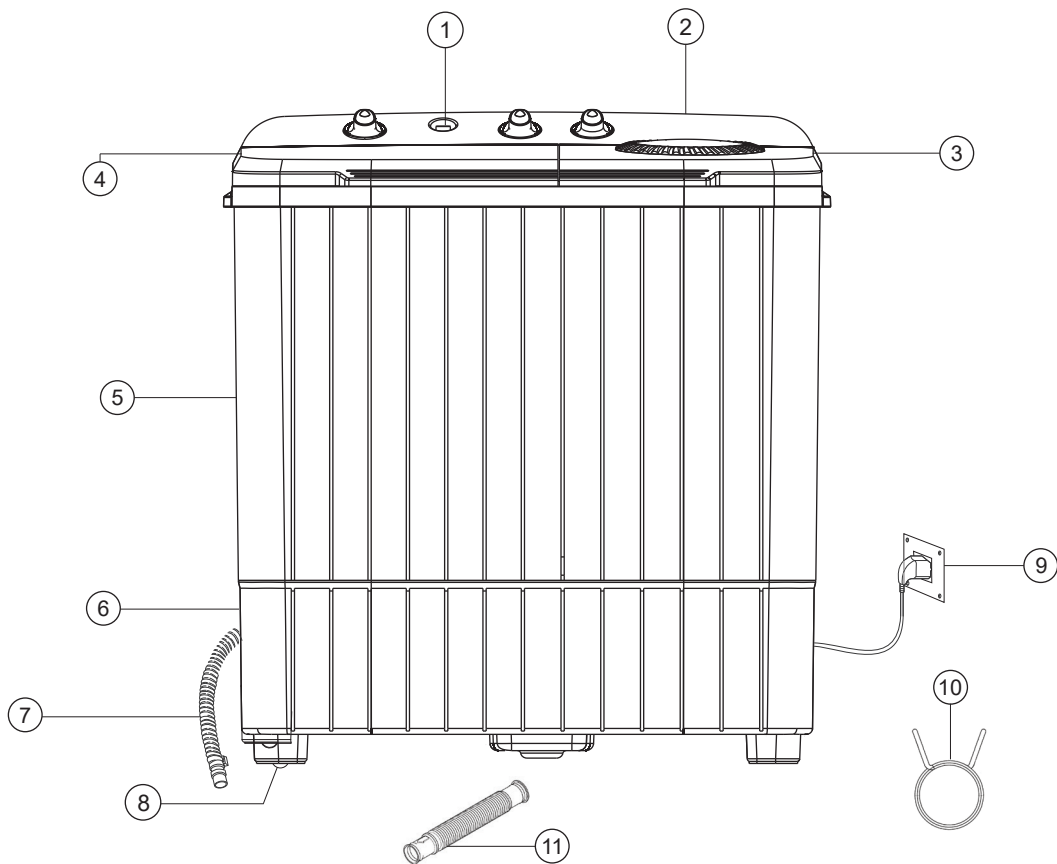

- | | |
|-----------------|-----------------|
| ① Water Inlet | ⑦ Drain Pipe |
| ② Control Panel | ⑧ Castor Wheels |
| ③ Spin Lid | ⑨ Power Cord |
| ④ Wash Lid | ⑩ Hose Clamp |
| ⑤ Tub | ⑪ Inlet Hose |
| ⑥ Base | |

Note : Graphics and Images shown in manual may differ than actual product, it is for reference only.

Safety Precautions

1. Make sure that the washing machine is plugged to a 3 pin/5A electrical outlet and earth terminal is provided on the outlet.
2. Unplug the power supply cord when you do not use it.
3. To disconnect the washing machine from electrical mains completely, pull out the plug and do not pull it from the mains cord.
4. Don't allow your kids to look inside the washing machine while running.
5. This washing machine is meant for washing clothes with water as a medium. Do not use petrol or other chemicals. This can result in fire and damage.
6. Do not use water with temperature exceeding 50 degree C, as this deforms the plastic parts in the machine. If you desire to use warm water add hot water to cold water in the wash
Do not pour hot water in an empty tub.
7. Keep the machine away from flames and inflammable material. Do not expose the washing machine to direct sunlight or rain. Also avoid placing it in humid locations.
8. Take Precautions not to pierce the control panel membrane sheet.
9. Do not connect the earth wire to a phone wire, lightening rod.
10. Do not press the button with an awl or a pin.
11. Avoid overloading of wash and spin tub.
12. Do not use wash & spin tub for water storage.

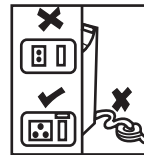

Care & Maintenance

Be sure to remove the power plug from main power supply before cleaning the machine and filter

Cleaning the Wash Tub

1. After washing is complete, fill fresh water above the level of pulsator without adding clothes.
2. Run the machine for 1-2 minutes turn the knob to "DRAIN" position when pulsator is still rotating.
3. When water is completely drained out, turn the knob to "WASH" position.
4. Finally turn off the machine.

Recommended washing procedure

1. Open the water tap and fill the wash tub about half way.
2. Put in the laundry detergent and allow it to disperse well.
3. Put in the clothes to be washed and add water in accordance with the amount of cloth load.
4. Set the WASH TIMER as desired depending on the fabric type and the degree of soilage.
5. When washing is finished, set the Drain Selector to Drain

NOTE: Ensure that the clothes rotate freely during wash, if not, reduce the cloth load. (By removing some clothes from the machine)

Rinsing and Drying Rinsing

There are 2 ways to rinse:

1. Rinse : Fill the wash tub appropriately for the number of clothes being washed. Set wash timer for 15 Minutes.
(Rinse will begin) and clothes will Rinse for a period of 15 Minutes.
2. Intermediate Spin Rinse: Put clothes inside the Spin Tub. Set Water to the marked level of SPIN TUB. Open the water tap and keep it open for one to two minutes and then close tap. Spin for one minute. When rinsing is over, set the Drain Selector to DRAIN. Do not keep the water tap open when the Spin tub is rotating, else machine will malfunction.

SPIN DRYING

Put clothes inside Spin Drum, distributing them evenly and ensure that the drain hose is lowered otherwise the machine will malfunction. After putting clothes in Spin Drum place spin Drum Cap over the clothes inside the tub to prevent them from flying out. Close the Spin Drum Lid. If the lid is not closed the Spin Drum will not rotate. Set the SPIN TIMER from 1 to 5 minutes according to the type of clothes. If the spin Drum starts shaking noticeably, open the lid and wait for the Spin Drum to stop spinning. Distribute the clothes evenly and re-start.

REFERENCE

TABLE 1. DETERGENT GUIDE

WASH LOAD	1.2~2.5 kg	2.5~3.8 kg	3.8~5.0 kg	5.0 kg or ABOVE
Water Level	Low	Medium	High	Over Flow
Amount of Detergent	40 gm	50 gm	60 gm	64 gm
Amount of concentrate Detergent	25 gm	30 gm	38 gm	40 gm
Amount of Softener	22 ml	26 ml	29 ml	35 ml

Table 2- LAUNDRY GUIDE

Amount of Laundry	Clothes System	Synthetic Fiber	Cotton	Heavy Stained Clothes
1.2 ~ 2.5 kg	Washing Time	2~5 minutes	7~10 minutes	10-15 Minutes
	Wash Selector	GENTLE	GENTLE*/ HEAVY	HEAVY
2.5 ~ 3.8 kg	Washing Time	7~10 minutes	10~15 minutes	Wash 15 minutes
	Wash Selector	GENTLE	GENTLE*/ HEAVY	HEAVY
3.8 kg and above	Washing Time	Wash 10~15 minutes	Wash 15 minutes	Wash 15 minutes
	Wash Selector	GENTLE	GENTLE*/ HEAVY	HEAVY

Notes:

- If the wash load and water volume do not match, clothes may damage/water splash may occur.
- The quantity of wash load varies depending on fabric type, thickness and size of the clothes.
- Adjust the water level/wash load as required by carefully watching the movement of the clothes in the tub.

Troubleshooting guide

TROUBLES	CHECK POINTS
Motor not working	<ul style="list-style-type: none"> • Check supply source. • Is the power cord firmly plugged in? • Is the timer turned to a suitable point except "OFF"? • Motor has been provided with "TOP" (Thermal overload protector). This will protect the motor from burning due to overheating caused by various variable factors such as overload voltage, frequency variation, etc. In such case motor supply will get off, thus stopping the motor. Wait for approximate ½ hour till motor cools to normal temperature. Restart the M/c to see if motor functions normally.
Spin dryer basket does not operate	<ul style="list-style-type: none"> • Is there any cloth dropped between the basket and tub? • Is the spin dryer cover closed? • Is the laundry gathered to one side of the spin dryer basket?
Drain not drawing	<ul style="list-style-type: none"> • Is the lint stuck to the plunger valve? • Is the end of the drain hose guide located at an excessive height?

Troubleshoot Table		
Problem	Reason	Solution
The pulsator does not rotate	Power out or switch off Transmission belt burst Pulsator is blocked by something	Switch on plug Assemble the transmission belt Remove the blockage
The pulsator rotates too slowly	Belt becomes loose The flexible screw of motor is loose	Tighten the belt or replace it Tighten the belt and the screw
Abnormal noise and vibration	The clothes in the spin-dry tub are unbalanced Something was stuck between pulsator and wash tub	Place the clothes neatly Remove it.
Water leaks from wash tub	The hose is not tightened with the wash tub	Tighten it

Usage instructions for semi-automatic washing machine

Step 1

- Select the wash option (Gentle/Heavy) on the selector switch.
- Wash: Put clothes in the wash tub with water and detergent. Start the Wash function.
- Pulsator will rotate and wash the clothes for 15 minutes

Step 2

- Place the clothes in the spin tub.
- Select spin timer for the time period required (5 mins).
- This is required to remove excess soap.
- Will result in the first drying process for the clothes.

Step 3

- Transfer clothes to the wash tub.
- Rinsing: Fill in water only and select wash time for 3-4 minutes.
- After this is complete, select the drain mode to drain out water.

Step 4

- Drying : Transfer clothes to spin tub and select spin time to complete final drying process.

SPECIFICATION

Model	LLWM01
Max. Rated Capacity Wash	6.5kg
Max. Rated Capacity Spin	4.5kg
Power Supply	230 V AC / 50 Hz
Washing Input	330W
Spinning Input	130W
Net Dimension in mm (WDXH)	750X450X875
Package Dimension in mm (WDXH)	815X495X930
Net Weight	18kg
Gross Weight	22kg
Water Capacity High	56L
Water Capacity Low	43L
Castor	Yes
Buzzer	Yes
Wash Timer	15Min
Spin Timer	5Min

WIRING DIAGRAM

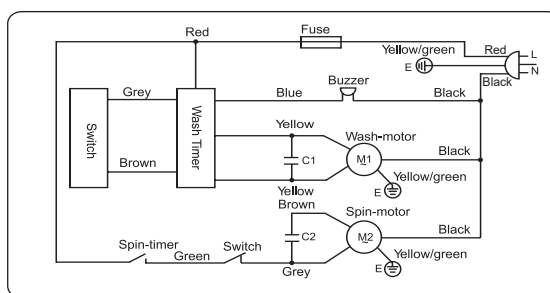

PACKING LIST

Name	Quantity
Semi Automatic washing machine	1
Spin-dry safety lid	1
Inlet pipe	1
User manual	1
Drain Hose	1
Hose Clamp	1

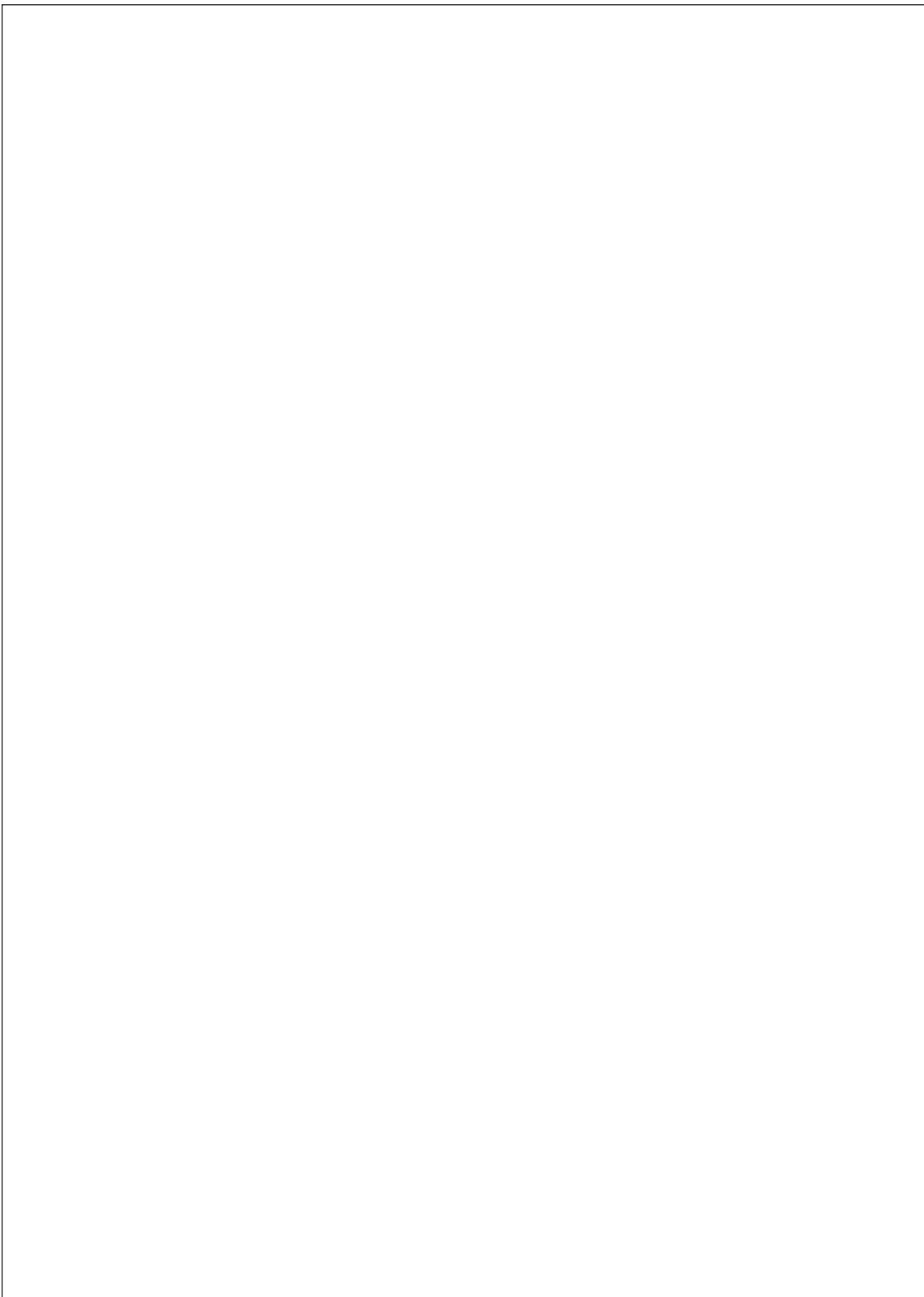

Thank you for using our washing machine.
Please tell us troubles found during using it.
Send your suggestions for improvement.