

lifelong

KITCHEN

MAKING IT POSSIBLE

Lifelong Wet Grinder



Due to continuous product improvement specifications are subject to change. Images shown are for illustrative purposes only and may differ from the actual product.

1 YEAR
WARRANTY

INTRODUCTION

Welcome to the Lifelong family,

Dear Customer,

Congratulations on purchasing Lifelong Table Top Wet Grinder and a warm welcome to the Lifelong family. At Lifelong, we take pride in developing quality products for your home, health and happiness. Through constant innovation in our products, we have been able to develop a wide spectrum of products across Home, Kitchen, Grooming and Wellness categories. We strive to enrich the lives of the modern consumer every day. Keeping that in mind, we have offered all our products at a fair and honest price.

We hope that the Wet Grinder serves you and your family's needs without any hassles.

Thanks again for becoming a part of the Lifelong family. Enjoy using the product!

Warm Regards,
Team Lifelong

CONTENTS

Identification of Parts	-	3
Technical Specifications	-	4
Features	-	5
Do's and Dont's	-	6
Time Chart	-	8
Operating Procedure	-	9
How to operate attachment	-	13
Additional tips	-	16
Trouble shooting	-	18

IDENTIFICATION OF PARTS

Now that you have unpacked your Lifelong Table Top Wet Grinder carton, get acquainted with the part names.

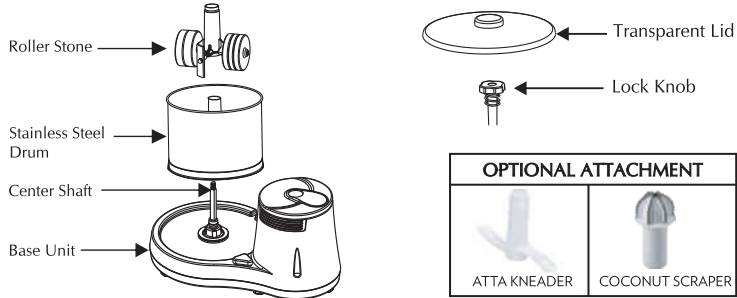

*Due to constant Research & Development, the parts supplied may differ from the images shown in this manual.

TECHNICAL SPECIFICATIONS

Product	:	Table Top Wet Grinder
Capacity	:	2 Litre (Soaked Medium)
Voltage	:	230V, 50Hz
Motor Rating	:	Single phase, High Torque Motor
Rated Input	:	260 Watts
Motor Output	:	150 Watts
Speed	:	1300 RPM.
Flexible cord	:	PVC approx. 2 Meters long with 6 Amps, 3 Pin Moulded plug
Package carton	:	292 X 310 X 480 mm
Warranty	:	1 Year
Attachments	:	Atta Kneader, Coconut Scraper

FEATURES

- Aethetically designed body.
- Body made of high quality ABS material.
- Portable and in a convenient size.
- A sturdy high torque, single phase motor.
- Detachable SS drum and roller stone assembly.
- Uniform griding pressure.
- Most hygenic.
- Easy-to-handle.
- Capacity 2 Litres.
- 1 year warranty.
- 150 Watts.

DO'S & DONT'S

DO's

- ✓ Always operate your grinder as per instruction given in this manual.
- ✓ Place your grinder at a convenient height on an even surface.
- ✓ Keep your grinder away from heat and sunlight.
- ✓ Keep your grinder clean and dry.
- ✓ Always operate your grinder at the specified voltage.
- ✓ Ensure adequate water in the medium for smooth and quick grinding.
- ✓ Handle carefully while fixing, removing and cleaning the attachments.
- ✓ Always lift the grinder by holding the base
- ✓ Remember to keep the switch in "OFF" position after use.
- ✓ Ensure disconnection from electrical mains after use.
- ✓ Close supervision is necessary when your wet grinder is used with children nearby.
- ✓ After use, clean the accessories, and keep them ready for future use.
- ✓ Any difficult in starting or in the operation of the grinder contact an Authorised dealer or manufacturer for assistance and resolving.

DONT's

- ⊗ Do not run the grinder without load.
- ⊗ Do not operate your grinder without fixing the transparent lid properly.
- ⊗ Do not burden motor with load heavier than specified.
- ⊗ Do not fix or remove attachments while the motor is ON.
- ⊗ Do not use any other attachments except those provided by the manufacturer.
- ⊗ Do not put your hands inside the drum while grinder is in operation.
- ⊗ Do not open lock knob while your grinder is in operation.
- ⊗ Never lay any thin plastic sheet or cloth under the basic unit. This may block the ventilation holes.
- ⊗ Do not let the cord come in contact with any hot object.
- ⊗ Do not store any items inside the drum.
- ⊗ Do not allow children to handle your grinder.
- ⊗ Do not pour water over your grinder.
- ⊗ Do not attempt to repair the grinder at yourself.

TIME CHART

Please follow the following instructions carefully before attempting to operate your Lifelong Table Top Wet Grinder

Medium	Max. Quantity (gms) 2 Ltr.	Soaking Time	Operating Time
Rice (Raw/Boiled)	1250g	4 Hours	30 Minutes
Dal (Urad / Toor/etc)	350g	4 Hours	30 Minutes
Coconut Shredding	1 Coconut	Not Required	10 Minutes
Masala Mixture of onions, chillies, shredded coconut, ginger, coriander garlic, jeera spices, etc.,	700g	Not Required	20 Minutes
Greens	500g	----	5 Minutes

Note : Soaking time / Operating time may vary according to the quantity and quality of the medium

OPERATION PROCEDURE

Follow the instructions carefully before attempting to operate your wet-grinder.

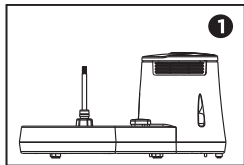

Position the grinder on a flat surface.

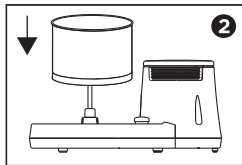

Place the drum over the centre shaft and rotate till the drum fixes itself properly.

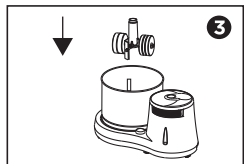

Place the roller stone assembly inside the drum.

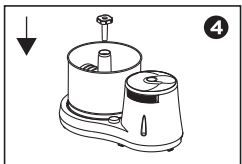

Fit the lock knob on the centre shaft and tighten.

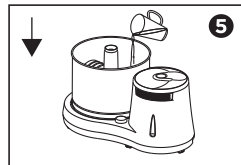

Pour some water in the drum.

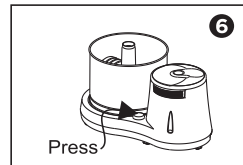

Switch ON the grinder.

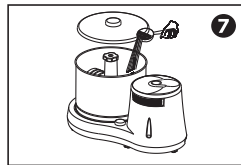

Add grinding medium in small quantities with adequate water.

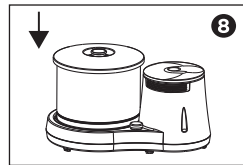

Fix the transparent lid back on the drum.

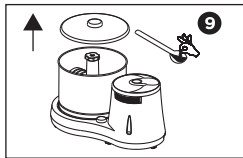

Periodically check the consistency of the batter using the spatula by opening the transparent lid.

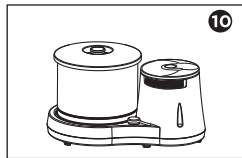

When required consistency is achieved, switch OFF the grinder.

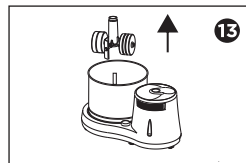

Lift the roller stone assembly.

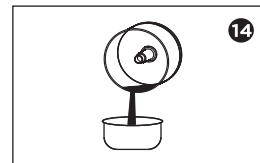

Remove the drum and collect the ground medium.

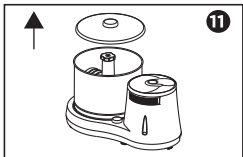

Remove the transparent lid.

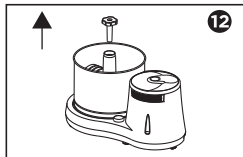

Unscrew the lock knob.

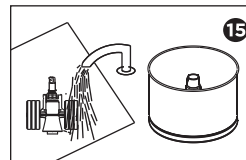

Clean the roller stone assembly thoroughly to clear any residual medium.

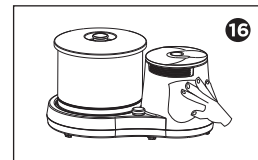

Clean outer surface with a damp cloth. Wipe it dry, with a clean soft cloth.

OPERATION PROCEDURE

ATTA KNEADER



This is specially designed for kneading to the right consistency to make roti, chapati, puri and parotta

OPERATION

- Open the lid and remove the roller stone assembly.
- Place the Atta kneader on the centre shaft of the drum and fix the lock knob with few threads for proper kneading.
- Add atta flour pour some water and close the lid then switch ON the grinder.
- Add little oil and salt to taste and add water to get the required consistency.

COCONUT SCRAPER



This is specially designed for scraping coconut to utmost convenient and fitness.

OPERATION

- Remove the Drum.
- Place the collecting plate on the base and fix coconut scarper on the centre shaft.
- Switch ON the grinder. Then hold the coconut scraper.
- After scraping, remove the scraper and collect the medium.

IMPORTANT SAFEGUARDS

- Read all the instructions carefully and be thoroughly familiar with your grinder before use.
- Close supervision is necessary while using your wet grinder.
- Do not place your grinder near heat sources.
- Do not operate the grinder without fixing the lid properly.
- Do not allow children to handle your grinder.
- Handle carefully while fixing, removing and cleaning the attachments.
- Do not fix or remove attachments while the motor is ON.
- Do not let the cord come in contact with any hot object.
- To protect against electrical hazards, do not immerse base, plug or cord in water or other liquid.
- Always lift the grinder holding the base.
- Remember to keep the switch in "OFF" position after use.

CLEANING AFTER USE

- Clean the drum, roller stone assembly and other attachments in running water by using a nylon brush.
- Clean the body, base and cord with a damp cloth. Wipe them dry with clean soft cloth.
- Do not use rough cloth or abrasive scouring powders. These will leave marks and scratches on the body of the grinder and the accessories.
- After cleaning them dry wiping with a damp cloth and then dry well. This will free the appliance from existing food odours and keep them ready for future use.

ADDITIONAL TIPS

- In case of operating the grinder without any load (grinding medium), stone surfaces contact directly and would generate stone wear and sound. This should be avoid.
- Similarly when a small quantity of grinding medium is used, the stones will generate a little bit of sound due to direct contact of stone surfaces. This need not be considered as a problem in the grinder.

- Whenever less water is used in the medium, the thick paste collected near the roller stones may not allow the roller stones to rotate freely. Grinding can be continued by adding some water or by clearing the accumulations using the spatula.

- In case of return, power after a shutdown during grinding, the loaded drum at times may not rotate. To restart the grinding operations, in switch off position, remove some quantity of grinding medium or add some water and then switch on the grinder.

- If any of the stones does not rotate freely in its position, it needs to be checked whether any physical obstruction is there, due to presence of unground / ground food material. The same has to be cleared for a smooth and free rotation. If any of the stones does not rotate at all, ensure it should be referred to the Authorized service center or the manufacturing for servicing.

TROUBLE SHOOTING

PROBLEM	REASON	WHAT TO DO
• Unit does not start	• No power supply • Plug not properly inserted	• Check mains • Insert properly in socket
• Unit starts, but drum halts suddenly	• Excess quantity of medium • Insufficient water in the medium	• Remove the medium, add in small quantities • Add sufficient water
• Motor stops while grinding	• Insufficient water in the medium • Low voltage	• Add sufficient water • Operate between 200V to 240V, 50Hz
• Unit is noisy	• Incorrect wiper position	• Fix correctly by adjusting the nut
• Vibration in Unit	• Uneven platform	• Keep the Unit on an even surface
• Over heating	• Low voltage • Over loading of medium • Ventilation blocked • External heat source	• Operate between 200V to 240V, 50Hz • Remove the medium, add in small quantities • Clear the vents using a dry brush • Place the unit away from heat sources
• More time for grinding	• Over loading of the medium • Insufficient soaking time • Incorrect wiper position • Low voltage	• Remove medium add in small quantities • Soak, as per instructions given in the manual • Fix correctly by adjusting the nut • Operate between 200V to 240V, 50Hz
• Unit smells	• Motor burnt	• Call service centre
• Unit cycles ON & OFF	• Faulty switch	• Call service centre
• Roller stone not rotating	• Over loading of the medium • Insufficient water in medium	• Remove the medium add in small quantities • Add sufficient water
• Problems not listed	---	• Call service centre

Consumer Warranty Card

Dear Customer,

Thank you for choosing a Lifelong consumer product. All Lifelong Consumer products are designed and manufactured to the highest standards to deliver high quality performance, as well as easy installation and use. At Lifelong, we believe in providing not only service, but adding value to your purchase. The warranty has therefore been designed especially for you with your interest at heart.

Warranty Service

All Lifelong consumer products are covered against manufacturing defects from their date of purchase.

Name of the product: _____

Model: _____

Warranty coverage: 1 year

Please note: Purchase receipt is necessary for warranty verification.

Customer Care: customercare@lifelongindia.com

Customer Details

Name: _____

Address: _____

Home Number: _____

Office Number: _____

E-mail Address: _____

Product Details

Model No.: _____

Serial No.: _____

Purchase Date: _____

Invoice Number: _____

Online Site: _____

Please log onto to www.lifelongindiaonline.com and complete the online warranty form with your personal and product details within 14 days.

Terms and Conditions:

1. This warranty is void if:

- The completely filled warranty card is not presented at the time of servicing the product.
- The product is not operated according to the instructions given under the user manual.
- Damages are caused by lightning, abnormal voltage, water or other liquid intrusion, fire, flood, accident, negligence or improper handling.
- Product has been damaged due to installation, repairs, alterations or modifications by unauthorized service organizations or persons.
- Product label specifying the model number, serial number and production code has been removed and altered.
- Defects or parts requiring replacement due to ordinary wear and tear, corrosion, rust or stains, scratches, dents on the casing or paintwork of the product.
- Claims damaged and/or missing parts (accessories) after 7 days from the original date of goods received.
- Defects or faults in product which have been used for commercial/industrial purposes or which have been rented/leased or have been otherwise subject to non-household/non-domestic use.

2. Repairs or replacements will be carried out by authorized service provider.

3. During the limited warranty period, Lifelong or its authorized service provider will repair without charge the defective unit inclusive of labor and parts and restore the unit to its optimum working condition. All defective parts used for the warranty repair should be surrendered to Lifelong and/or its authorised service.

4. All expenses incurred in collecting the unit (s) or part(s) thereof from authorised service provider as well as any other expenses and incidentals will be borne by the consumer.

5. Lifelong obligations are limited to the repair and replacement of the defective product. Except as set forth above, there are no other express or implied warranty and all warranted, conditions or other terms implied by statute or common law (including any warranty of satisfactory quality, merchantability or fitness for a particular purpose) are excluded to the fullest extent permitted by the laws.

6. Lifelong total liability for damages relating to or arising out of the purchase or use of the product regardless of the type or cause of such damage of the form of characterization of the claim asserted (e.g. contract or tort) shall not exceed the original purchase price paid for the product.

7. However in no event shall Lifelong and Lifelong authorized distributors be liable for any punitive, special incidental, indirect or consequential losses or damages whatsoever (including without limitation, damages for the loss of revenue, business, profits, goodwill, or contracts, business interruptions, loss of business information or any other pecuniary loss.) Whether or not Lifelong has been advised of the possibility of such damages. These limitations shall apply not with standing the failure of the essential purpose of any limited warranty. This limited warranty does not affect consumer's statutory rights under the law.

8. No carrier, dealer or employee is thereof authorized to make modifications to this warranty and you should not rely on any such representation. Lifelong reserves the right to amend the terms and conditions if necessary.

For queries and complaints:
please contact: customercare@lifelongindia.com
www.lifelongindiaonline.com

Customer care: +91-9711558877